



MODEL #
529

ADULT FERRET HOME / TRAVEL CAGE

Instructions online at www.prevuepet.com

CUSTOMER SUPPORT

Please contact Prevue Pet Products:

PHONE 1 (312) 243-3624

ONLINE www.prevuepet.com

EMAIL customerservice@prevuepet.com

TOOLS NEEDED : Pliers for crimping • For best results, follow Assembly Steps in the order they are presented.

KEY:

M = Mesh

P = Platform

B = Base

R1 = Ramp (long)

C = Clips

R2 = Ramp (short)

1 PIECES

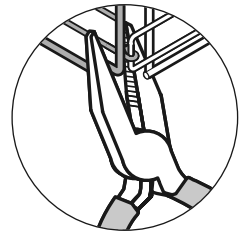
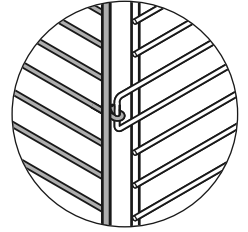
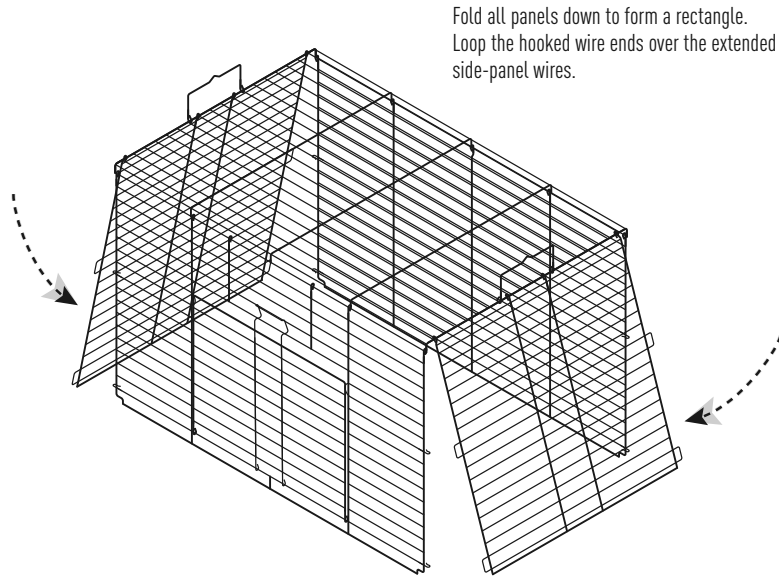
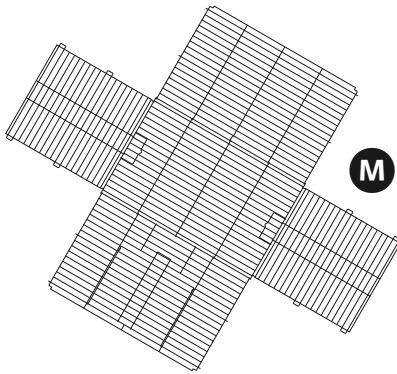

Crimp the hooks over the wires in all the corners to secure the mesh closure.

2 PIECES

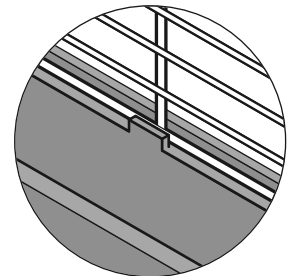
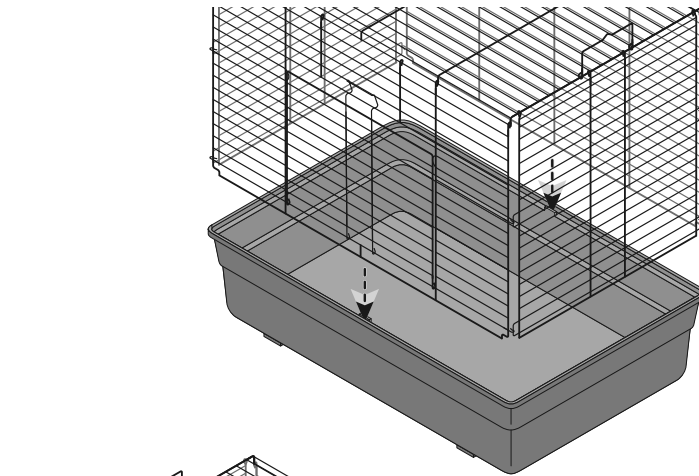
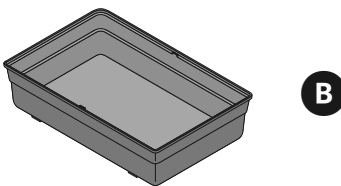

Set the mesh into the base. Align the mesh between the inner tab and the outer rim.

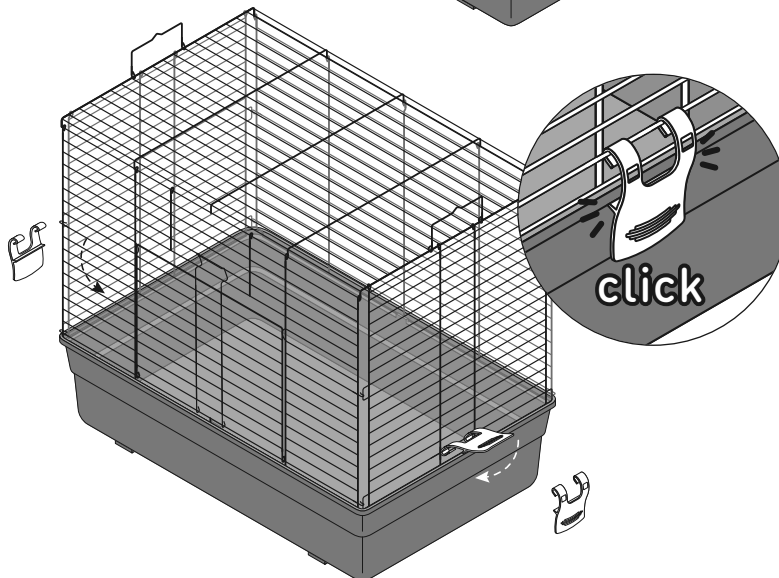

Hook the clip onto the cage mesh, between the two vertical wires. Swing the clip down and clip it onto the base. It is installed correctly when it "clicks" into place.

3 PIECES

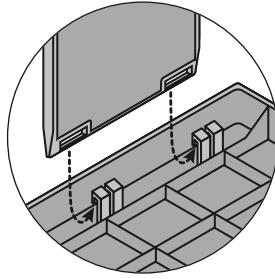
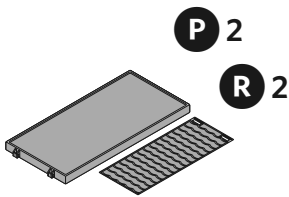
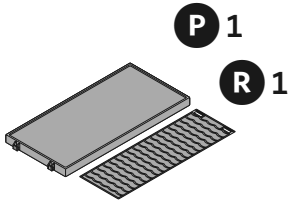

Link the long ramp onto the hooked posts on the underside of the platform.

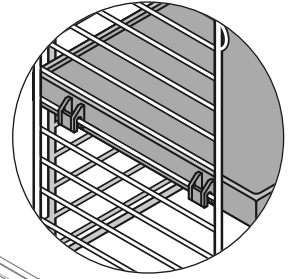

Hook the platform tabs over the mesh wire, front and back.

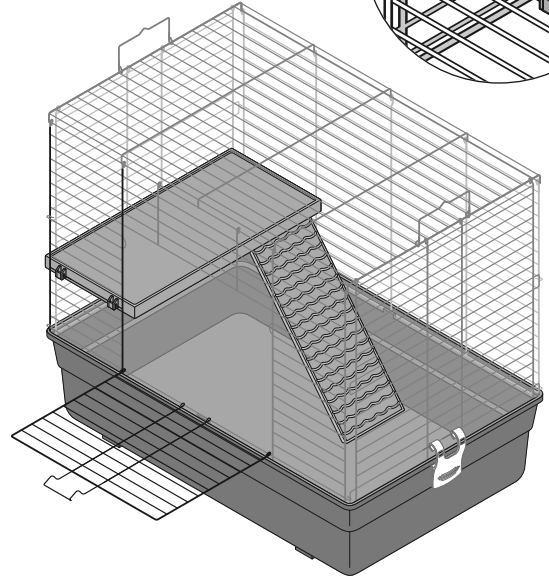
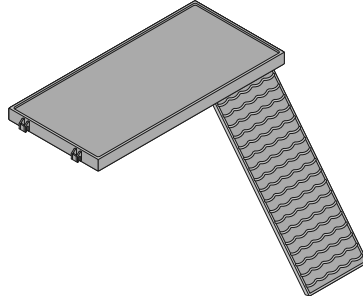

Link the short ramp onto the remaining platform.

Install the second platform higher than the first, bridging the platforms with the ramp.

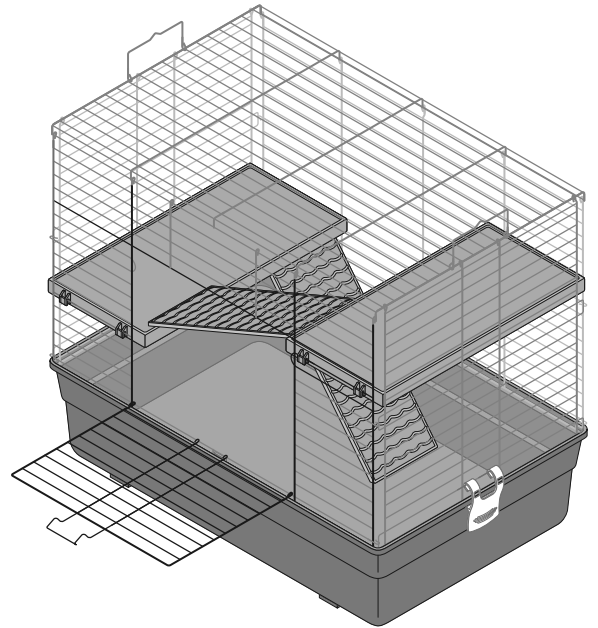
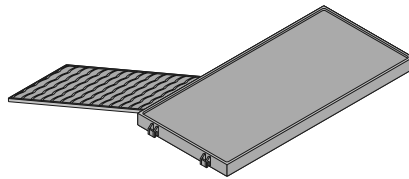

CLEANING INSTRUCTIONS

Prolong the life of your Prevue cage with these recommendations:

- When cleaning the cage and parts, use a soft cloth or Teflon-resistant scrubber such as Prevue's #109 Cage Saver non-abrasive scrub pad.
- Wash all parts with warm water and a mild environmentally-friendly, pet-friendly soap.
- Rinse thoroughly.
- Hand dry all parts completely with a soft dry cotton cloth before reassembling the cage.
- Do not leave plastic parts to dry in the sun as they may warp.

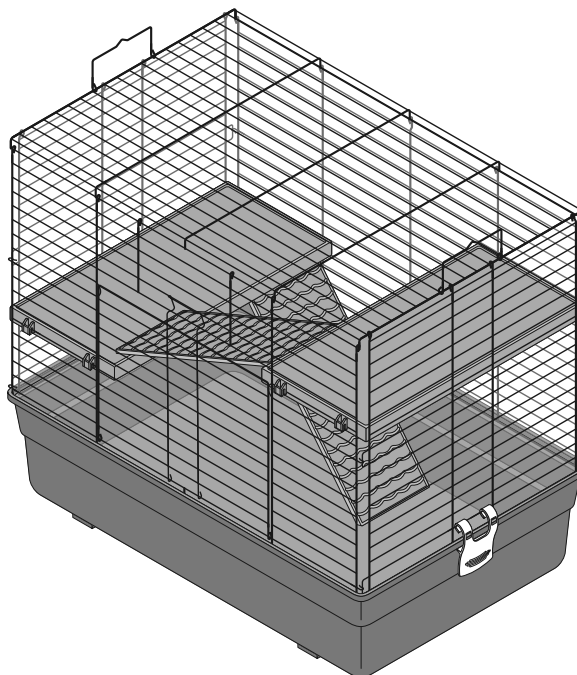

Assembly completed. ■