

# 1

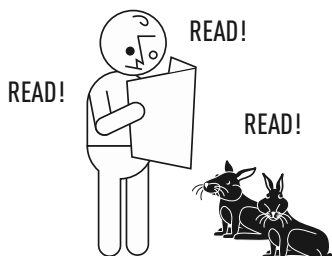

## READ THESE INSTRUCTIONS!

If you've never followed instructions before, this is a good time to start! These tips have been compiled to lead you to a successful assembly. We know you can do this!

If you run into trouble, contact our Prevue Customer Service team via email ([customerservice@prevuepet.com](mailto:customerservice@prevuepet.com)) or through our website ([www.prevuepet.com/page/5/replacement-parts](http://www.prevuepet.com/page/5/replacement-parts)).

# 2

## FIND A LEVEL SURFACE

Build your hutch on a flat surface and—with a friend—carry it to the location where it will be used. Assembling the hutch on the flattest surface available will help you greatly when squaring up panels and aligning the roof panels.



# 3

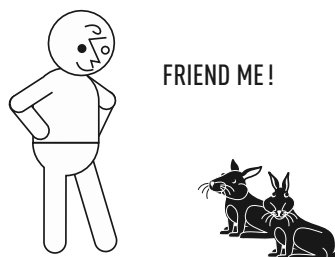

## FIND A FRIEND (or GO IT ALONE—both are OK)

If you follow these steps, hutch assembly will be easy for one person. But you may find a second person's assistance useful in some steps.

If you have to move the assembled hutch to its final location, you will definitely need assistance to protect the integrity of the structure.

# 4

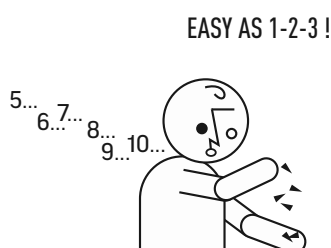

## COUNT CONTENTS OF HARDWARE PACKETS

After unpacking all components, count the contents of the screw packets. Compare the counts against the Parts List on the next page. There should be at least one spare for each packet. If any packets are short, please contact Prevue or use your own appropriate-size replacements.



For successful assembly of your Rabbit Hutch with Double Run

# Hop down this path

Instructions online at [www.prevuepet.com](http://www.prevuepet.com)

# 5



## CARE ADVISORIES

For the comfort and health of your bunny, this hutch size is most appropriate for 1 small to medium size rabbit or 2-3 dwarf rabbits.

- 

When moving the hutch, remember the ramps are on hinges and will dangle down below the base when the hutch is lifted off the ground.

### CUSTOMER SUPPORT

Please contact Prevue Pet Products:

**PHONE** 1 (312) 243-3624

**ONLINE** [www.prevuepet.com](http://www.prevuepet.com)

**EMAIL** [customerservice@prevuepet.com](mailto:customerservice@prevuepet.com)

These instructions are online, under the item's detail listing at [www.prevuepet.com](http://www.prevuepet.com).

**To maintain the longevity of your hutch when used outdoors, we recommend that you periodically treat it with a non-toxic sealant and protect it with a tarp or other covering during extended periods of inclement weather.**



For more wonderful cages, toys, and accessories for dogs, cats, birds, chickens, rabbits, ferrets and small animals, visit [www.prevuepet.com](http://www.prevuepet.com)

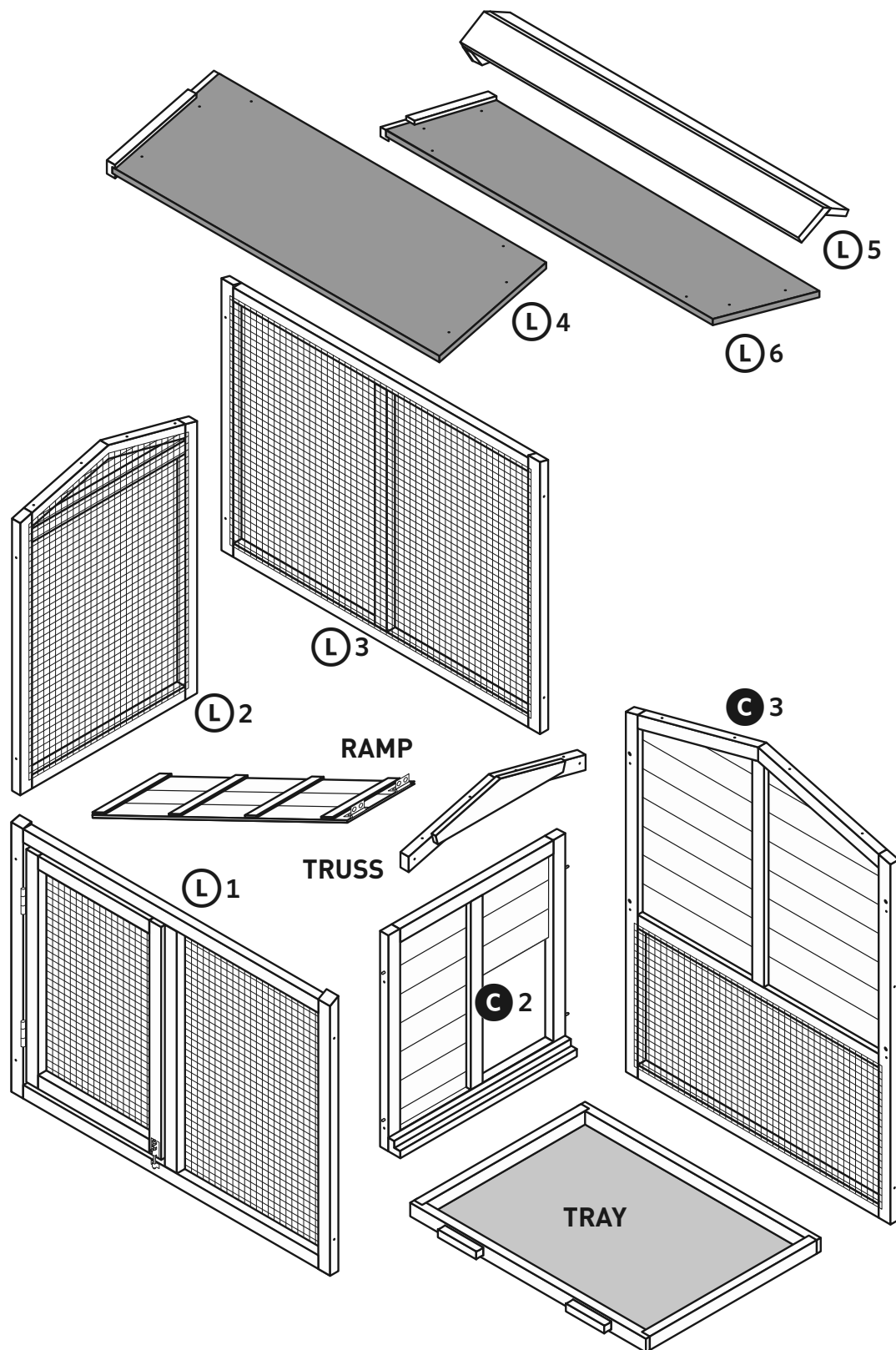

**KEY:**

C = Center Hutch Pieces

L = Left Side Pieces

R = Right Side Pieces

**HARDWARE INCLUDED:**

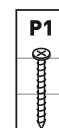

**P1**  
**2"L (50mm)**  
**8 pcs +1**

(use All in Step 2A+2B)

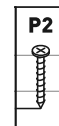

**P2**  
**1 1/16"L (40mm)**  
**16 pcs +1**

(use All in Steps 1 + 2)

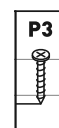

**P3**  
**1 3/8"L (35mm)**  
**4 pcs +1**

(use All in Step 2A+2B)

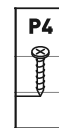

**P4**  
**1 1/8"L (30mm)**  
**24 pcs +1**

(use All in Step 3A)

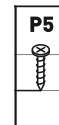

**P5**  
**1"L (25mm)**  
**12 pcs +1**

(use All in Step 3B)



**P6**  
**1/2"L (14mm)**  
**8 pcs +1**

(use All in Step 2A+2B)

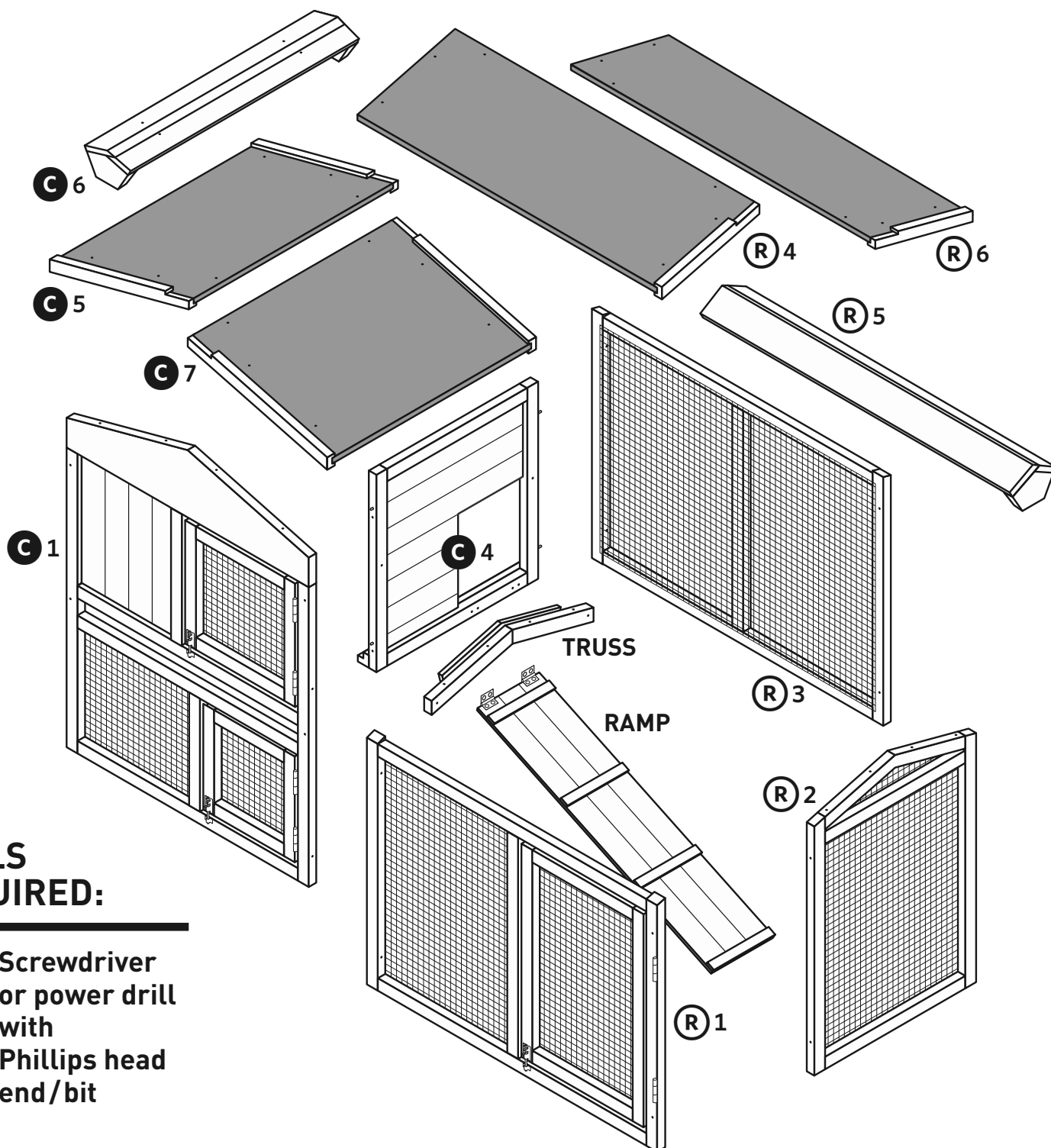

## TOOLS REQUIRED:

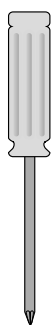

**Screwdriver  
or power drill  
with  
Phillips head  
end/bit**



# Rabbit Hutch with Double Run ASSEMBLY

Instructions online at [www.prevuepet.com](http://www.prevuepet.com)

## CUSTOMER SUPPORT

Please contact Prevue Pet Products:

**PHONE** 1 (312) 243-3624

**ONLINE** [www.prevuepet.com](http://www.prevuepet.com)

**EMAIL** [customerservice@prevuepet.com](mailto:customerservice@prevuepet.com)

TOOLS NEEDED : Phillips head screwdriver • For best results, follow Assembly Steps in order presented.

### KEY:

C = Center Hutch Pieces

L = Left Side Pieces

R = Right Side Pieces

## 1 PIECES

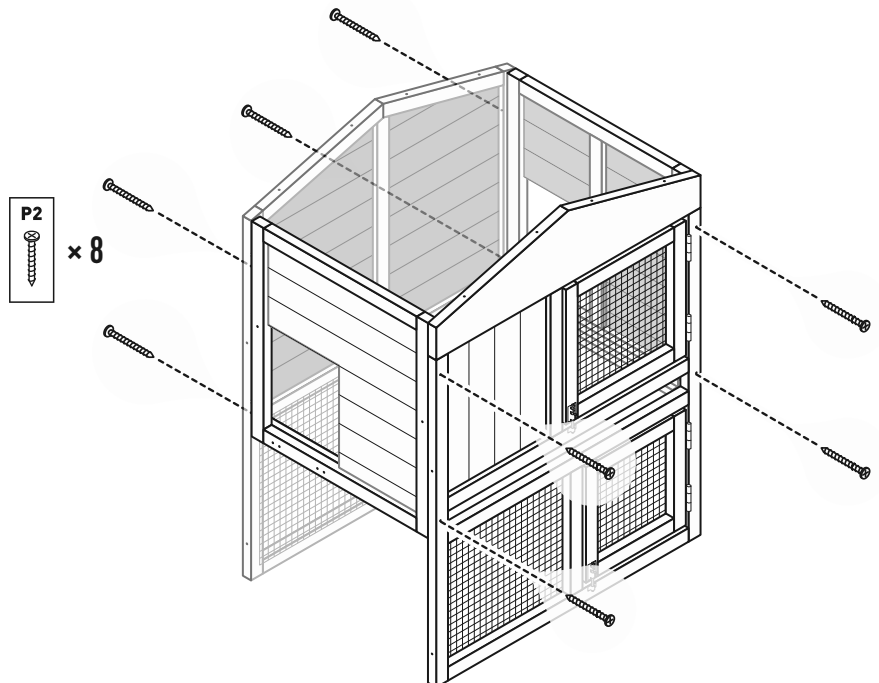
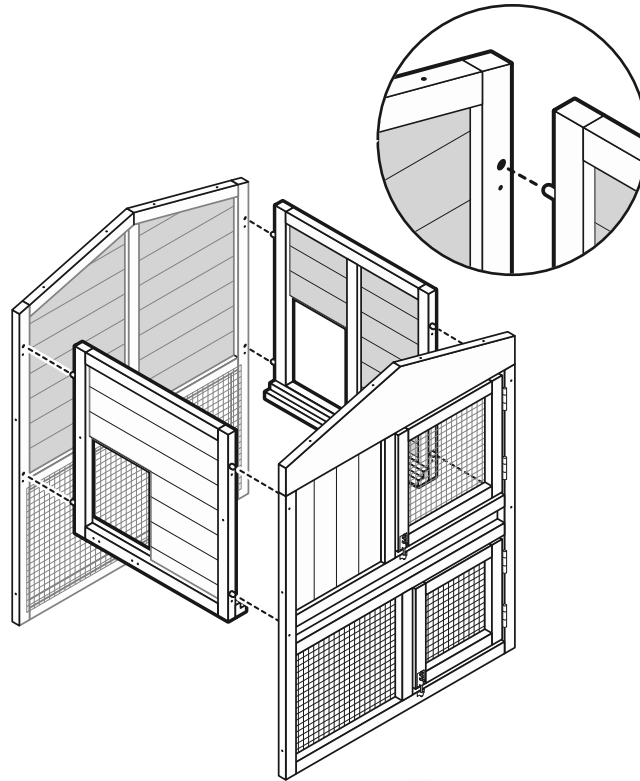
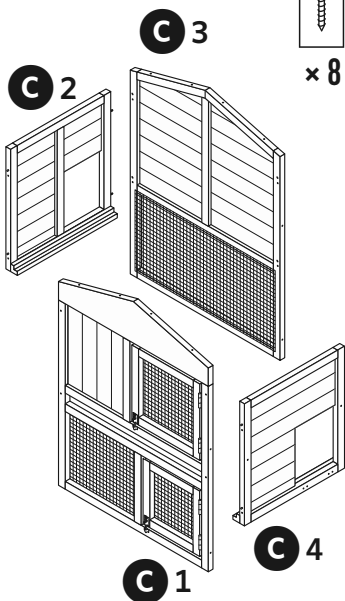

# 2a

PIECES

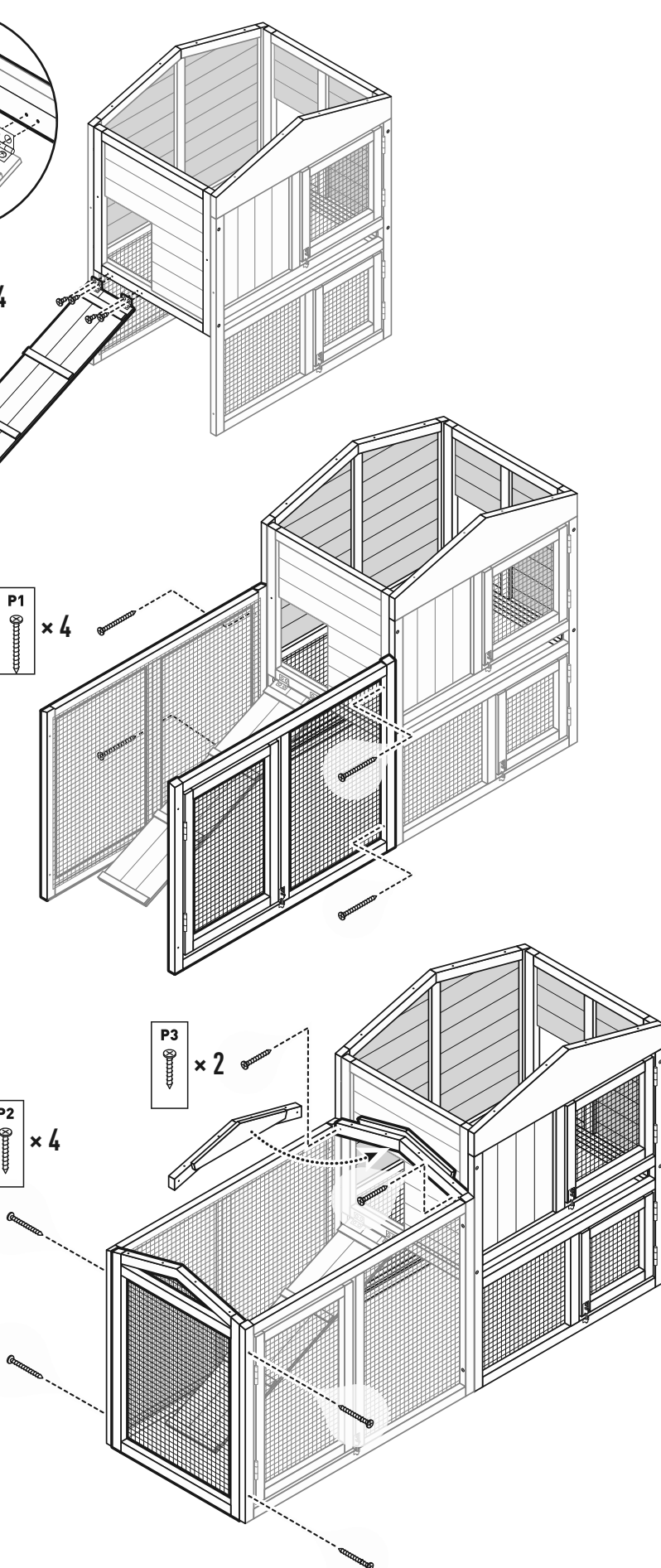
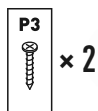
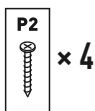
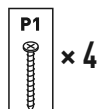
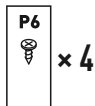
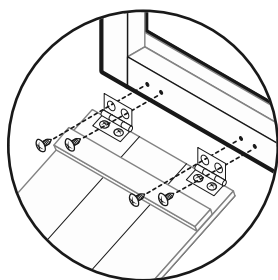
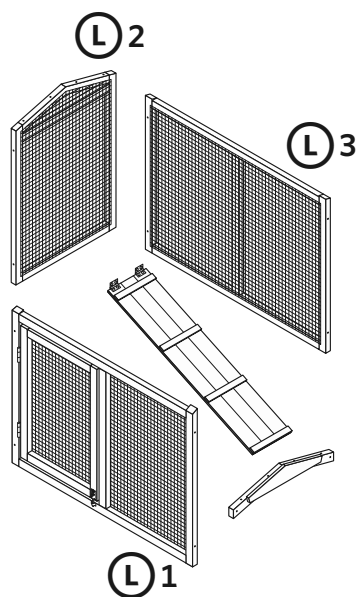
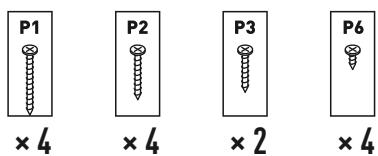

continues next page

# 2b

PIECES



x 4

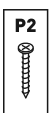

x 4

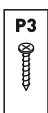

x 2



x 4

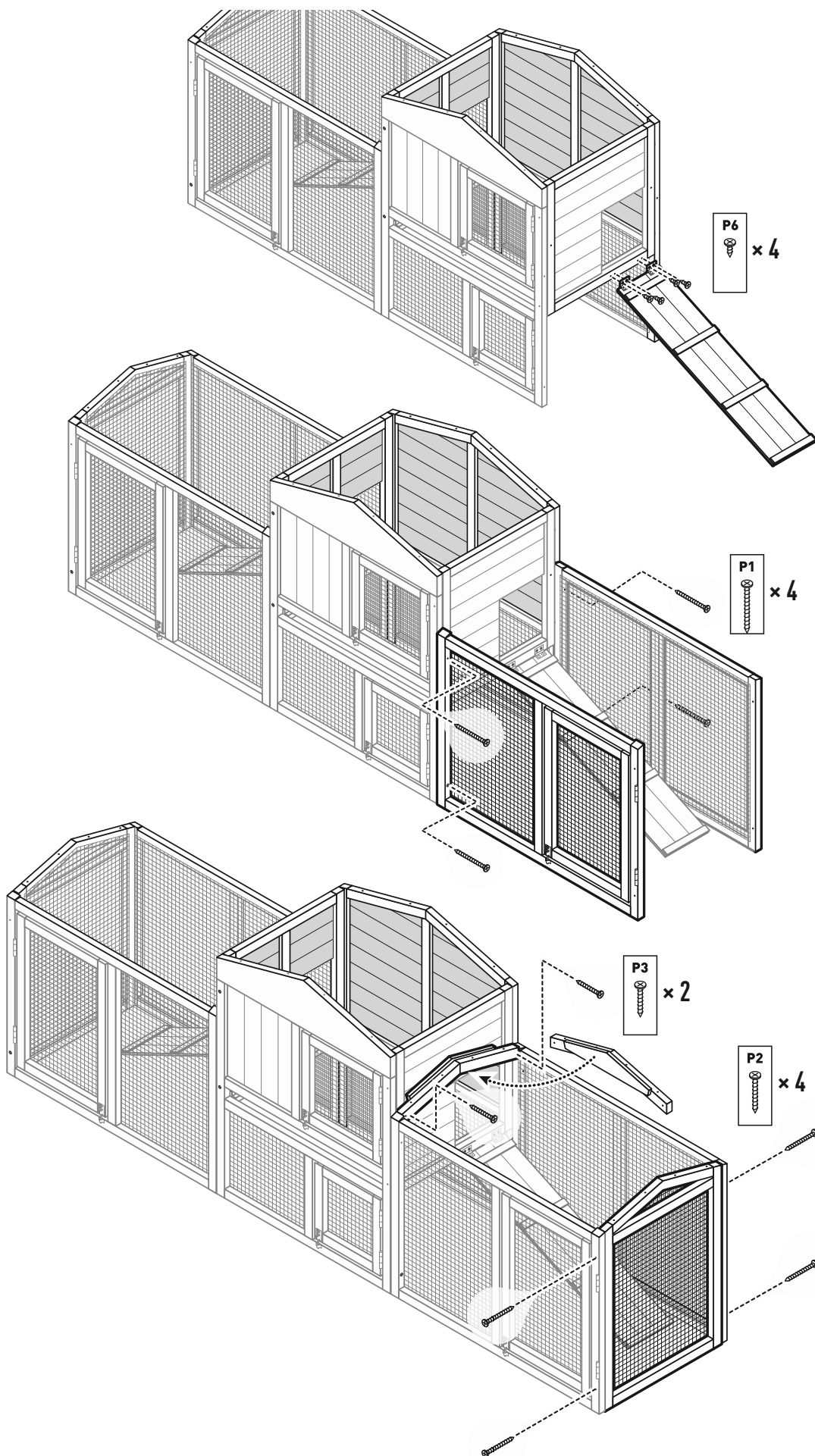
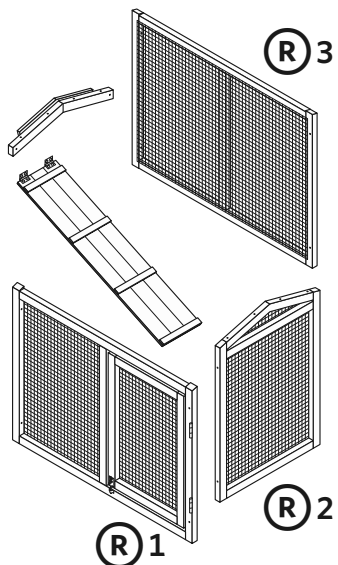

# 3a

PIECES

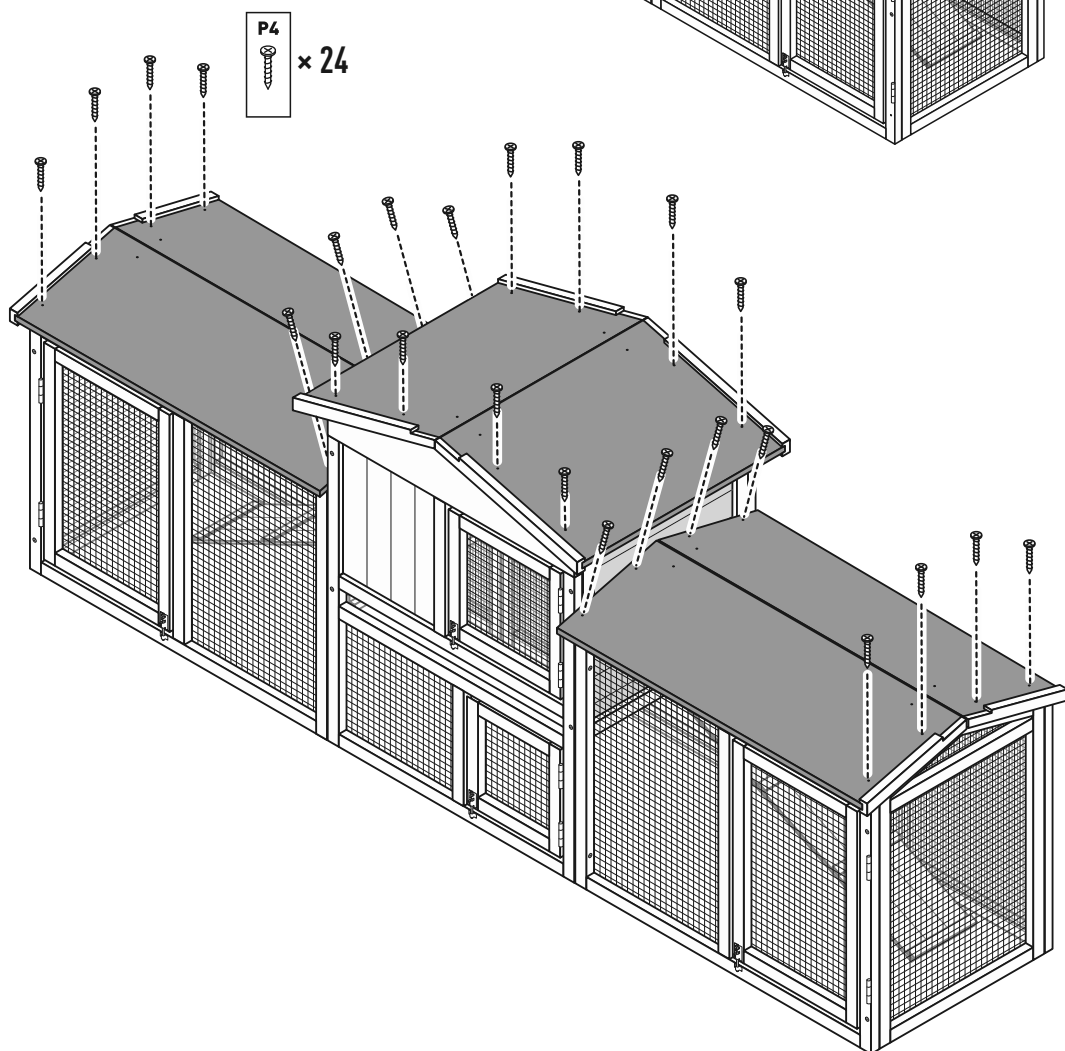
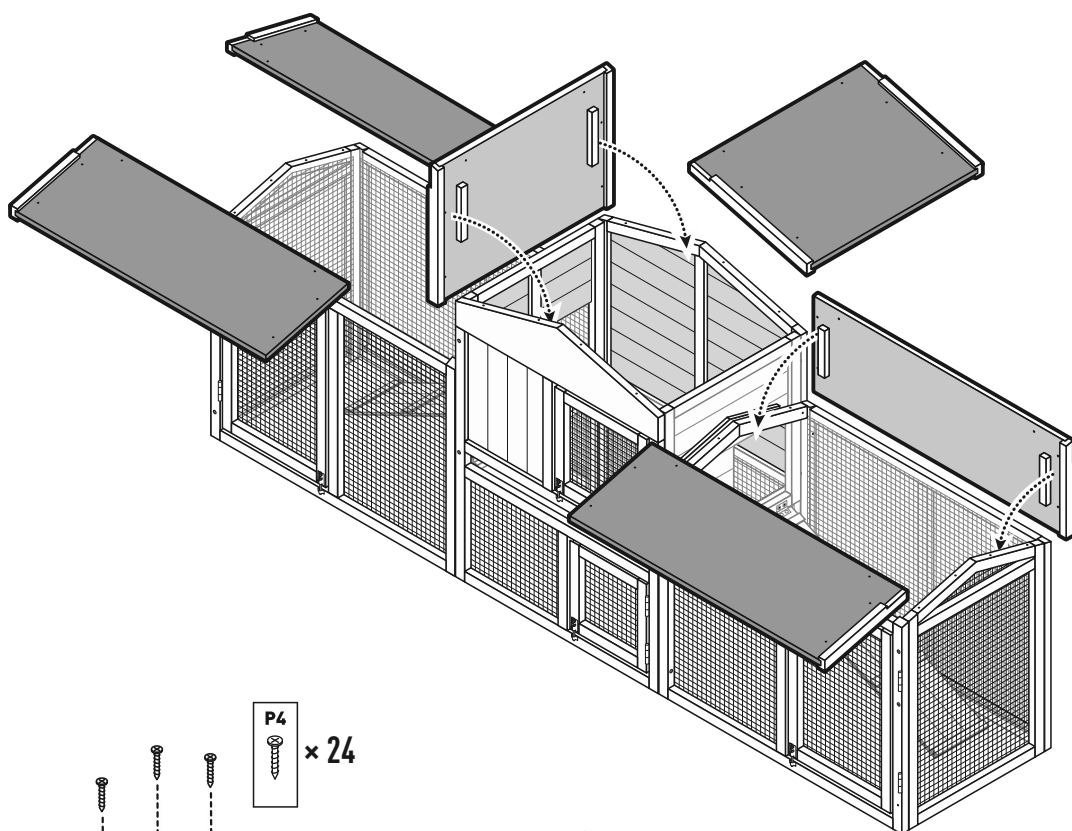
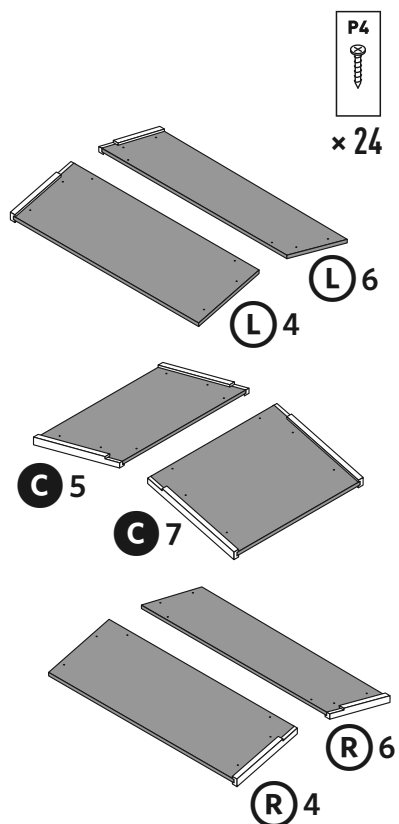

continues next page



# 3b

PIECES

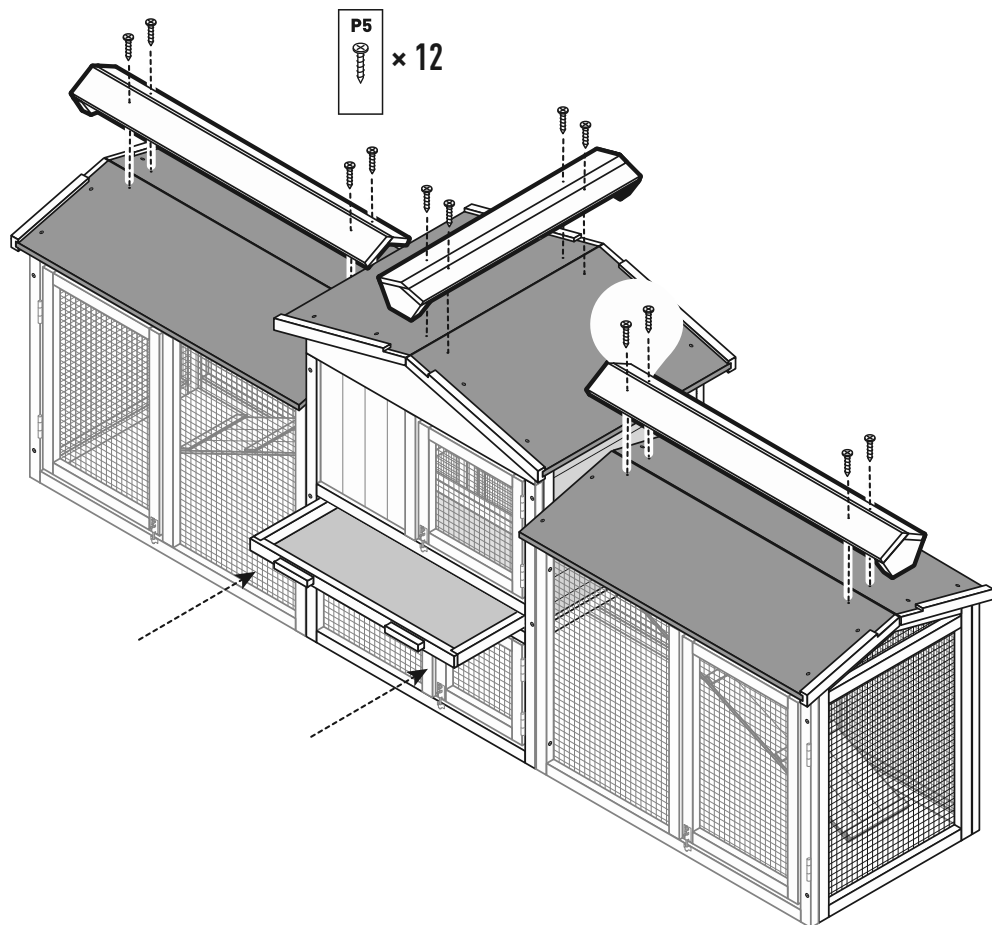
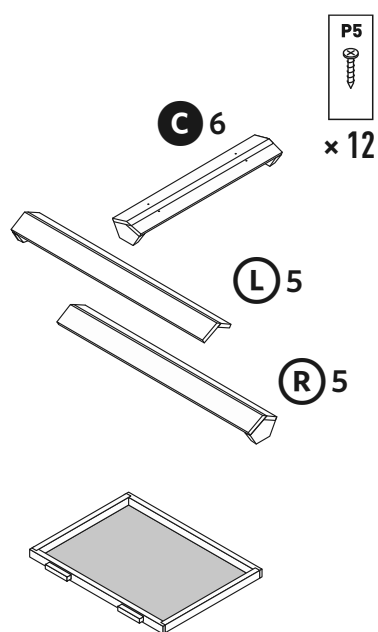

Assembly complete. ■

