

KEY:

SP = Spire
P = Post
DA = Day Bed
CB = Castle Banner
PL = Platform
HI = Hideaway
HP = Hideaway Post
BA = Base

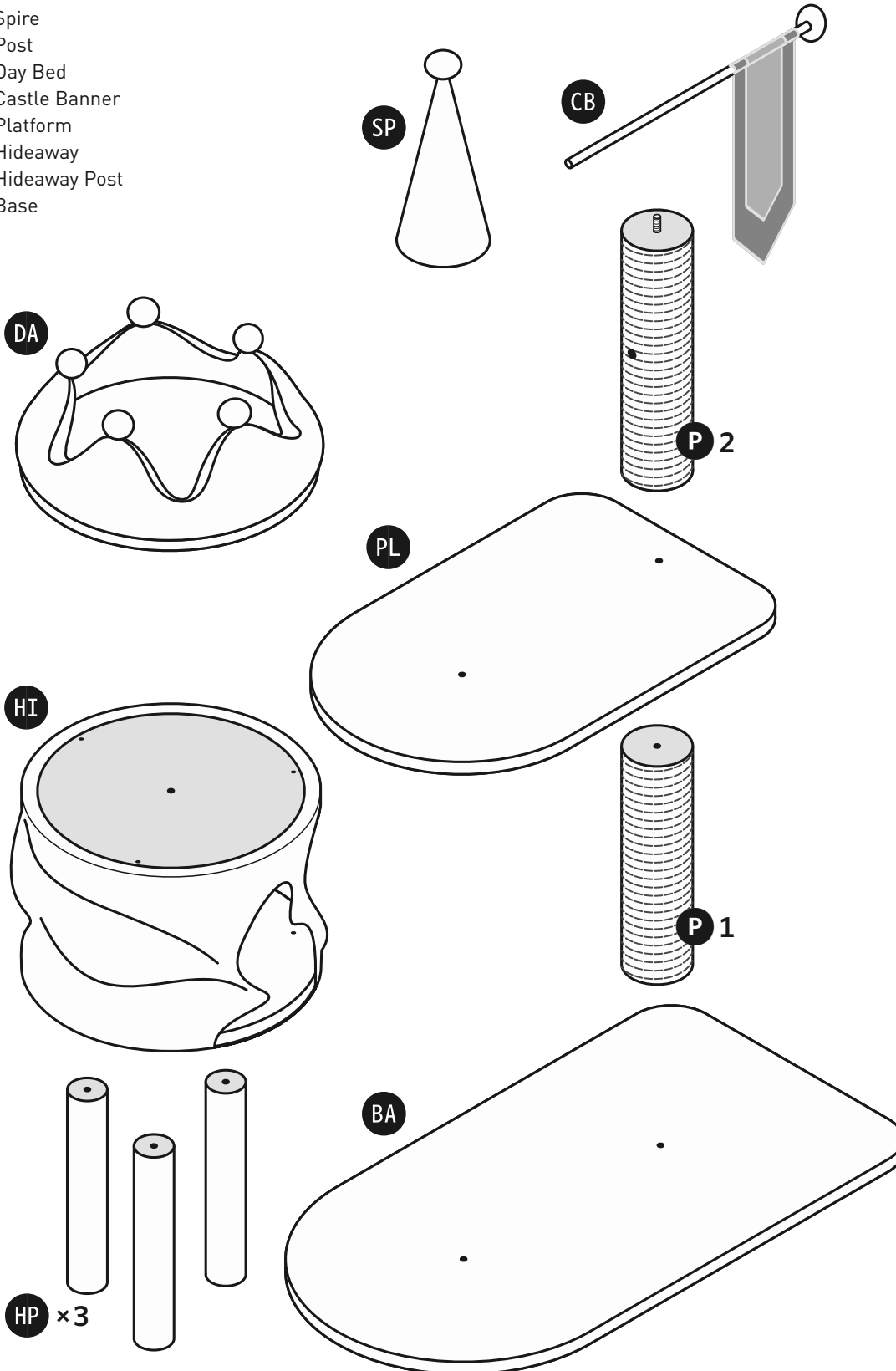

HARDWARE INCLUDED:



Phillips-head Screw
6 pieces



Short Hex Screw
1 piece



Medium Hex Screw
1 piece



Long Hex Screw
1 piece

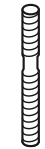

Screw Post
1 piece

TOOLS:

Hex Key



**Phillips-head
screwdriver**

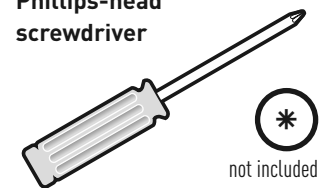

These parts are
interchangeable:
HP all three

TOOLS REQUIRED: Hex Key (included) & Phillips-head Screwdriver (not included) • Follow the Assembly Steps in the order presented.

1

PIECES

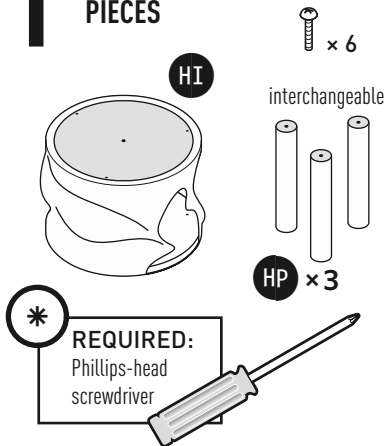

Insert the **hideaway posts** into the one-piece **hideaway** and stand them in their approximate positions. Affix the posts in place with phillips screws.

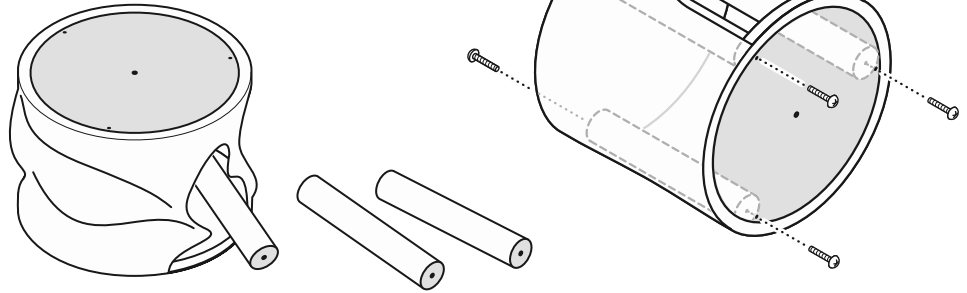

2

PIECES

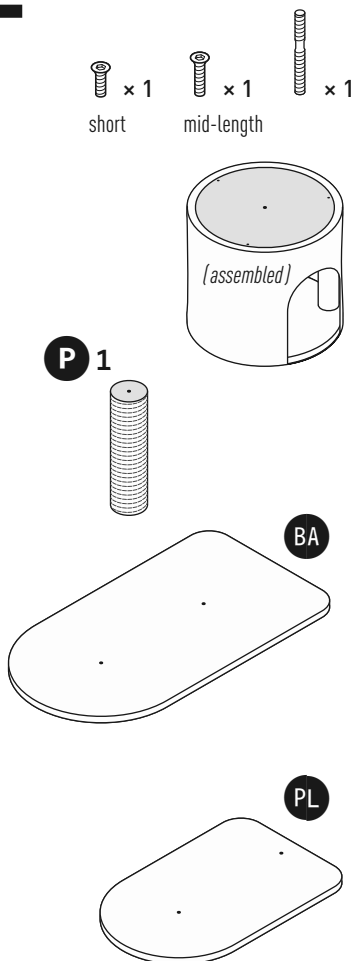

Affix the assembled hideaway to the **base** with the shortest hex screw.

Affix the shorter **scratching post** (without the integrated screw) to the base with the mid-length hex screw.

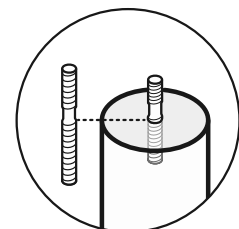
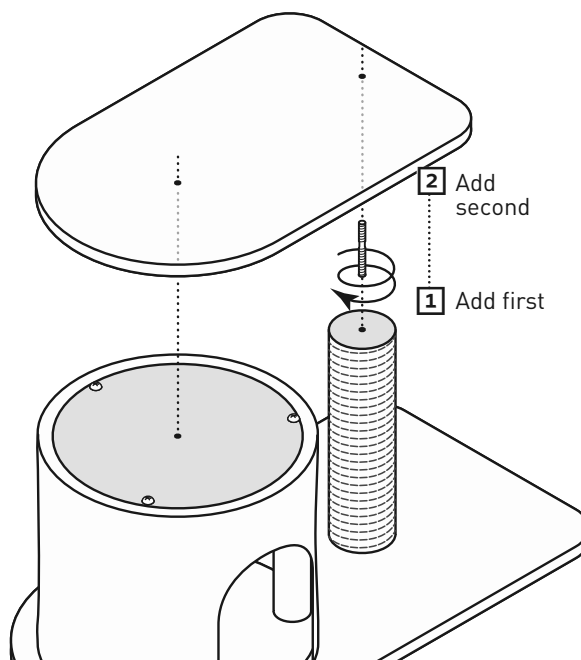
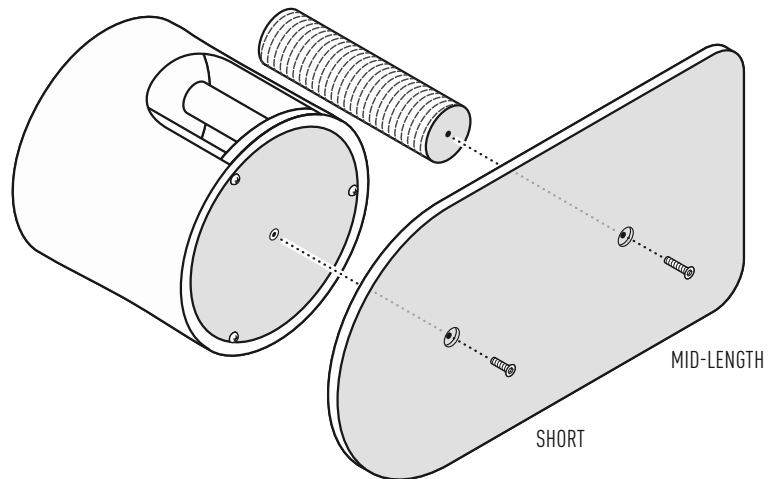

- ← **1** Set the **screw post** into the end of the scratching post.
2 Add the **platform** over the screw post and the hideaway.

3 PIECES

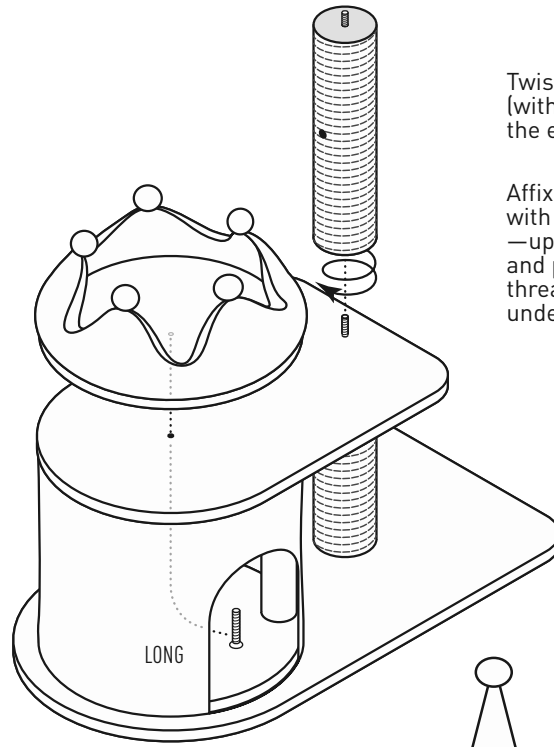
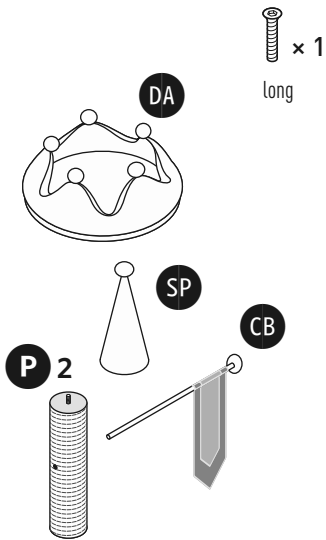

Twist the **scratching post** (with integrated screw) onto the exposed screw post.

Affix the **daybed** in place with the longest hex screw —up through the hideaway and platform, and into the threaded screw hole on the underside of the daybed.

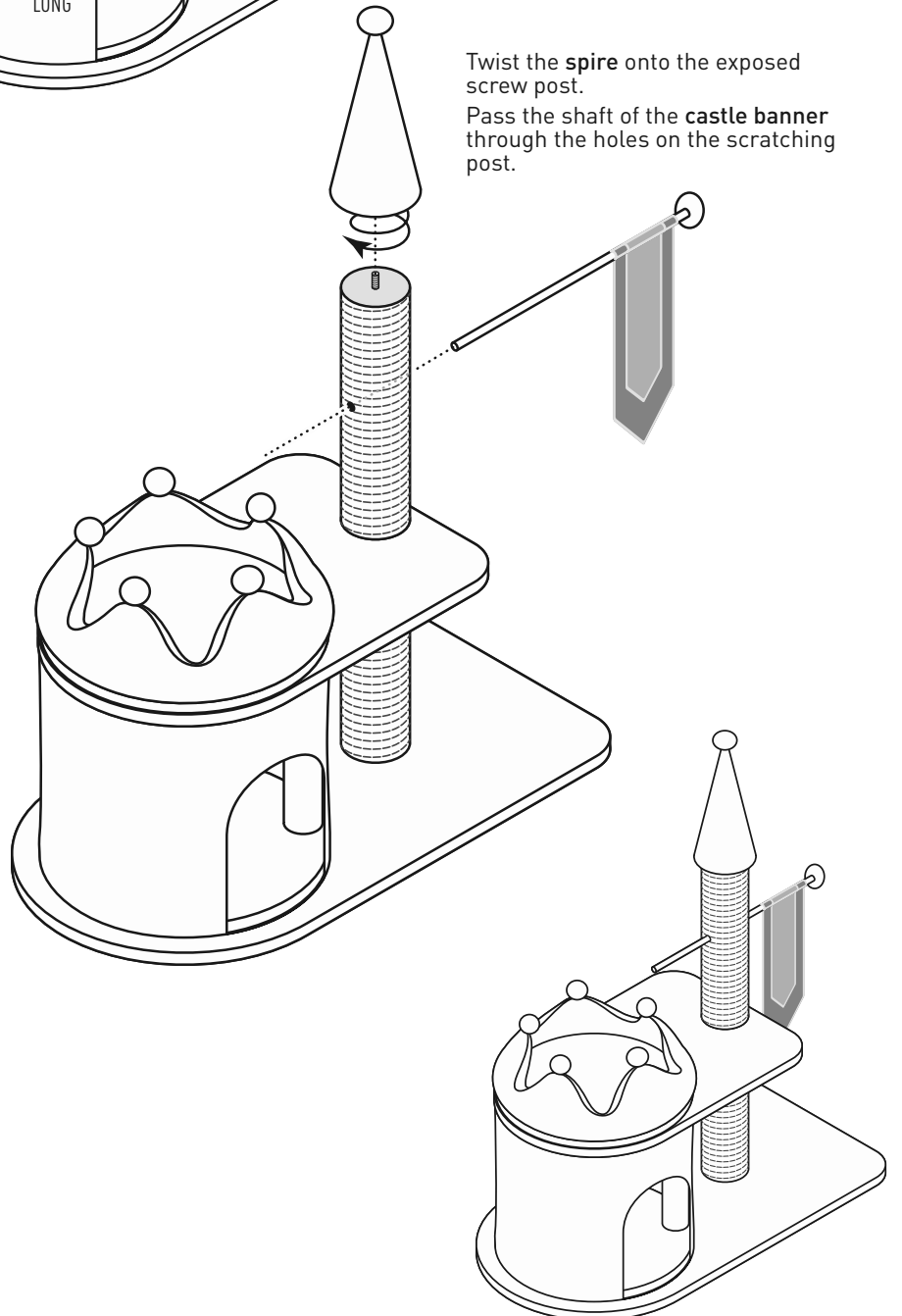

Assembly completed.