

**IMPORTANT:**  
**MAIN UNIT**  
 ON/OFF switch must be in the ON position for the device to operate.  
 To conserve power, or for long periods of inactivity, toggle the switch to the OFF position.

## LIGHT BEAM MAIN UNIT

**LIGHT BEAM**  
**Light Sequence:**  
 2 seconds ON / 1 second OFF

**AUTO Cycle:**  
 One 12-Second Cycle of the Light Sequence  
 (2 sec. ON / 1 sec. OFF / repeats 4 times)

**Specs:** 3 MHz  
 The light, light power and sequence timing is out-of-range for triggering seizures in individuals with light sensitivity. **Quiet Me** can be used safely by humans and birds.

### DEVICE MODES

**A** **AUTO Cycle**  
 One 12-Second Cycle  
 (2 sec. ON, 1 sec. OFF, repeats x4)

**M** **MANUAL (REMOTE ONLY)**  
 The Light Sequence will run only as long as the activation button on the Remote is pressed.

### TO ACTIVATE

**On the LIGHT BEAM UNIT:**  
 Press the button on the top of the unit.  
**A** (AUTO Cycle) only.

**On the REMOTE:**  
 Press the button on the face of the unit.  
**A** (AUTO Cycle) or **M** (Manual Light Sequence) will run, depending on toggle switch setting.

### LOW-POWER INDICATOR LIGHT

The red, blinking Low Power Light is activated when device is at 10% battery power.

- ⊗ Low battery: Red Light BLINKING
- Charging: Green Light ON
- Fully charged: Light is OFF

### RECHARGING

Use the charging cable (included) with any standard USB port to charge the LIGHT BEAM MAIN UNIT. When the device is charging, the Low Power Indicator Light will display GREEN. When fully charged, the light will turn OFF.

### PLACEMENT OF UNIT

Position the **Quiet Me** device with the light beam at eye level for your bird, and as closely as possible to the cage without being in reach.

Never place the device inside the cage.

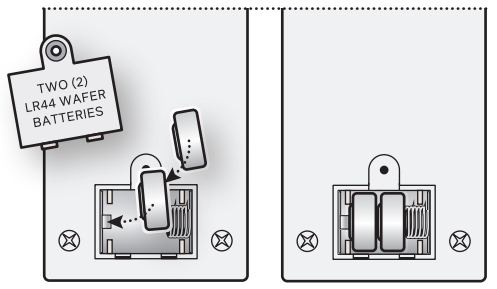
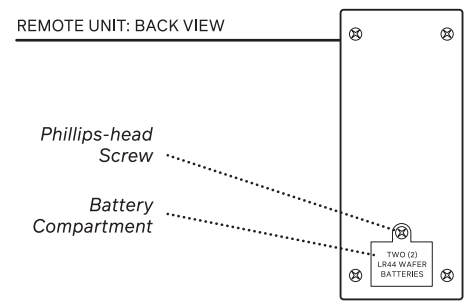
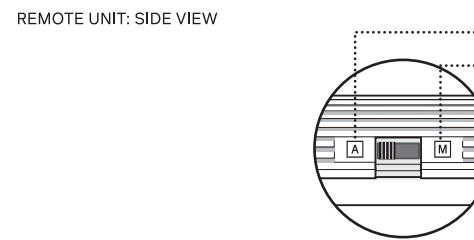
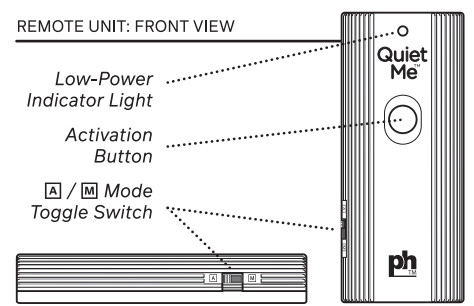

## HANDHELD REMOTE UNIT

**REMOTE**  
 The remote will activate the main device from within a distance of 150 feet, depending on obstructions.

### TO ACTIVATE

**On the REMOTE:**  
 Press the Activation Button on the face of the unit. The light will run in the **A** or **M** mode, depending on toggle switch setting.

### MODE SETTINGS

**A** **AUTO Cycle:** One 12-Second Light Sequence.  
**M** **MANUAL:** The Light Sequence will run only as long as the Activation Button is pressed. When the button is released, the light will stop.

On the side of the Remote, toggle the switch to the left (**A** AUTO) setting and press the Activation Button once to start the AUTO Cycle.

Toggle the switch to the right (**M** MANUAL), and press the Activation Button and hold it down. The Light Sequence will repeat as long as the button is pressed.

### LOW-POWER INDICATOR LIGHT

- ⊗ Low battery: Red Light ON
- Fully charged: Light is OFF

The red Low Power Light on the front/top end of the remote is activated with 10% battery power remaining.

### BATTERY REPLACEMENT

**Battery Type:** LR44  
**Batteries Required:** 2

The remote is powered by two (2) LR44 batteries, a common button coin cell battery, found online and at most retail outlets.

To replace the batteries, use a small electronics-type Phillips-head screwdriver to remove the screw holding the battery cover panel in place.

Remove the batteries, replace with fresh ones, and replace the cover and screw.



**THIS IS NOT A TOY**  
 This is a training device. DO NOT place **Quiet Me** inside your bird's cage, or leave it where your bird can reach it. Supervise your bird when **Quiet Me** is in use.



Prevue Pet Products, Inc. 224 N Maplewood Ave, Chicago IL 60612 USA • +1 (312) 243-3624 • www.prevuepet.com  
 customerservice@prevuepet.com • Since 1869

