

### KEY:

P1 = Two Posts: 19" / 48,2 cm

P2 = One Post: 13 1/4" / 33,6 cm

P3 = Two Posts: 11 3/4" / 30 cm

P4 = Four Posts: 8 1/4" / 21 cm

DB = Daybed

PS = Platform - small

PL = Platform - large

B = Base

HR<sup>U</sup> = Hideaway Roof - upper

HR<sub>L</sub> = Hideaway Roof - lower

HC<sup>U</sup> = Hideaway Cover - upper

HC<sub>L</sub> = Hideaway Cover - lower

HB<sup>U</sup> = Hideaway Base - upper

HB<sub>L</sub> = Hideaway Base - lower

HP<sup>U</sup> = Hideaway Post - upper

Four Posts: 8" / 20,3 cm

HP<sub>L</sub> = Hideaway Post - lower

Four Posts: 10 3/8" / 23,8 cm

### HARDWARE :



**Phillips-head Screw**  
**16 pieces**



**Short Screws**

**A = 28mm L**

**B = 24mm L**



**Long Hex Screw**  
**7 pieces**

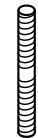

**Screw Post**  
**2 pieces**

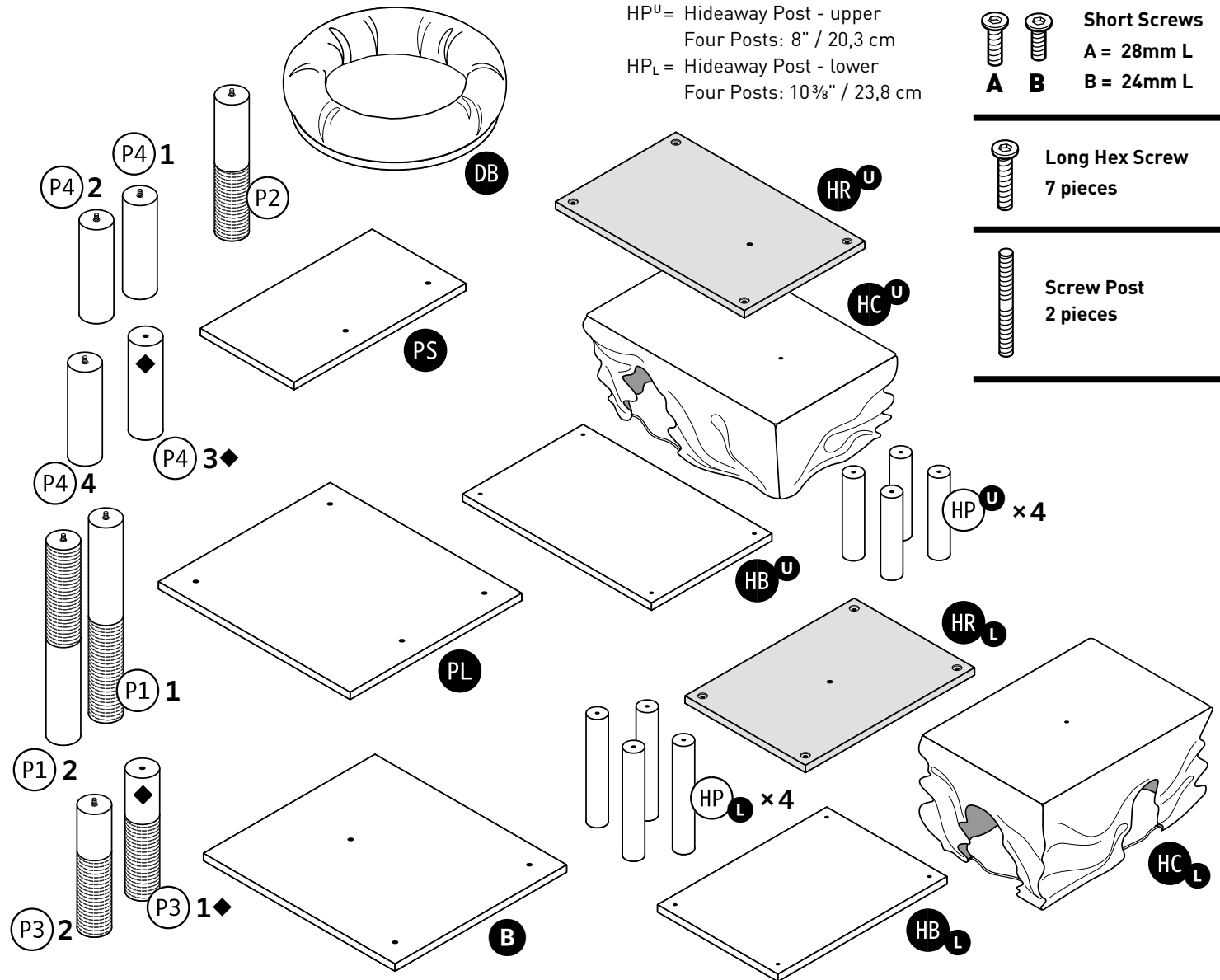

These parts are interchangeable:

(P1) 1 = (P1) 2

(P4) 1 = (P4) 2 = (P4) 4

(HP<sup>U</sup>) all 4 posts

(HP<sub>L</sub>) all 4 posts

◆ indicates ends without  
an Integrated Screwpost

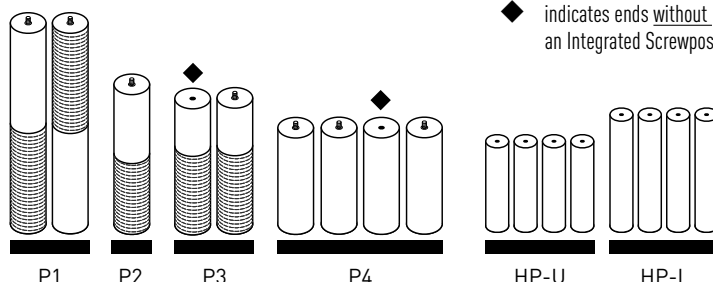

### TOOLS NEEDED :

**Hex Key**

included

**Phillips-head  
screwdriver**

not included

TOOLS REQUIRED: Hex Key (included) & Phillips-head Screwdriver (not included) • Follow the Assembly Steps in the order presented.

## 1 PIECES

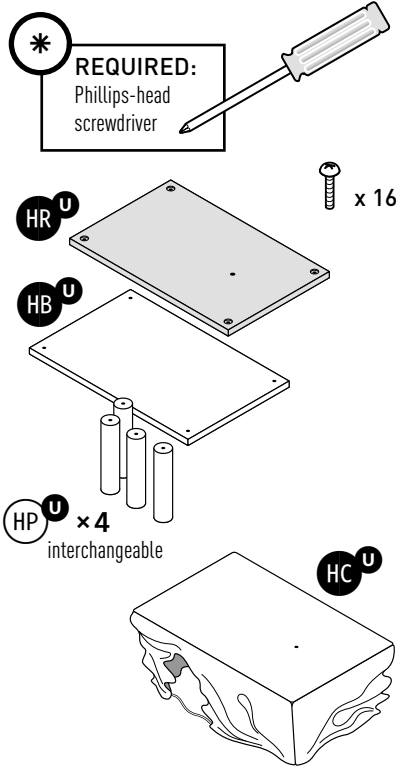

### UPPER HIDEAWAY

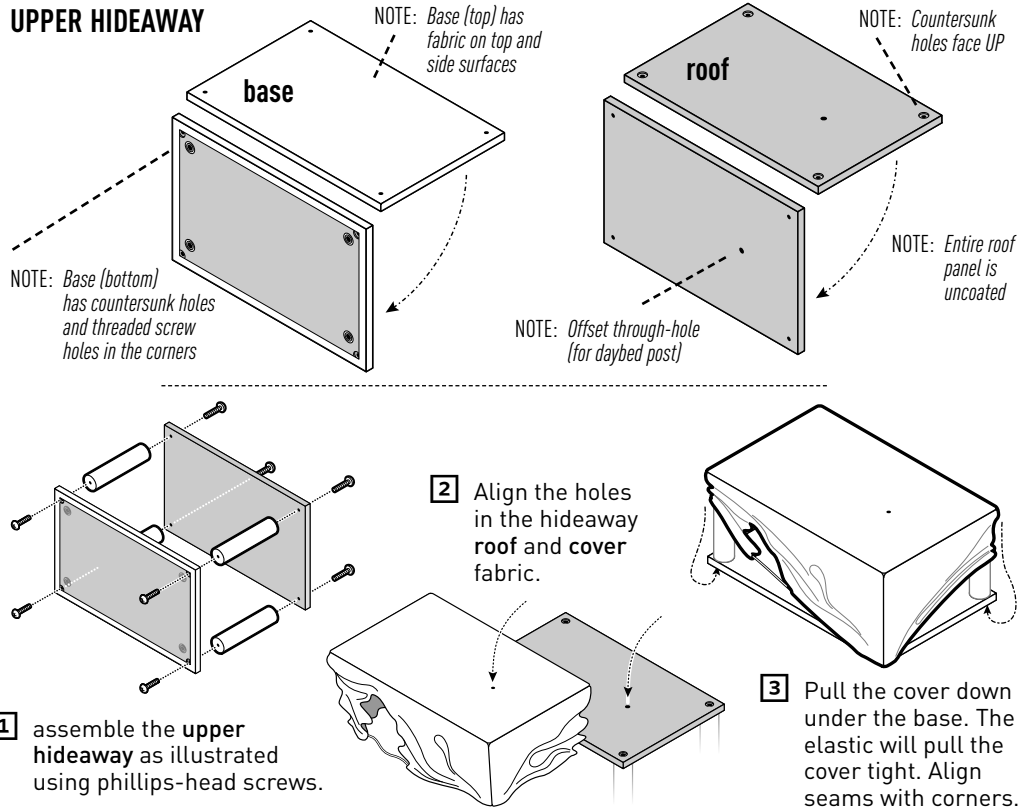

### LOWER HIDEAWAY

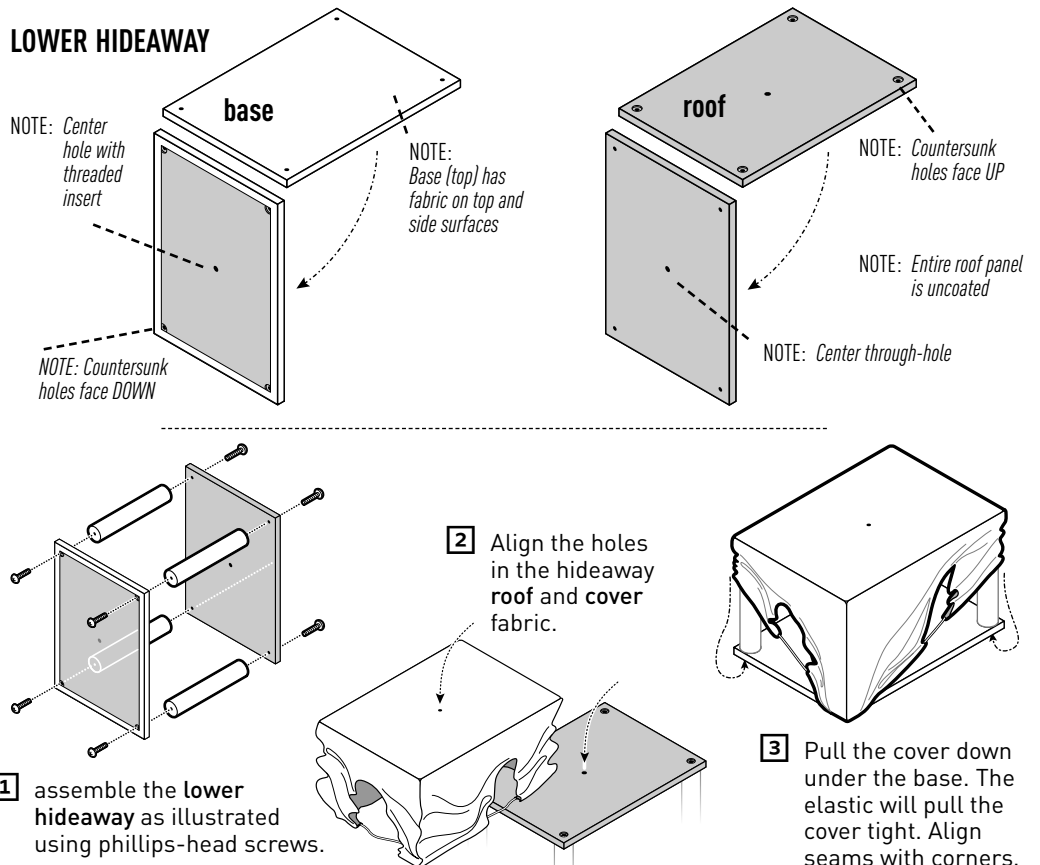

## 2 PIECES

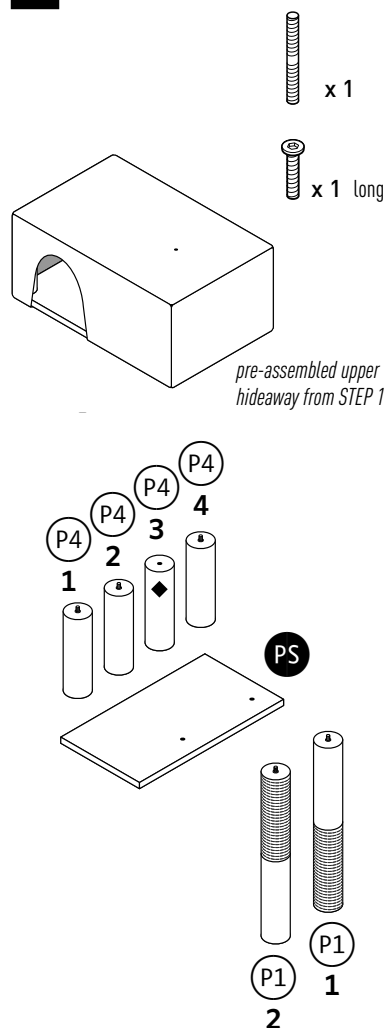

◆ indicates end without Integrated Screwpost

twist the **P4 posts** into the threaded holes on the left end of the **top hideaway base**

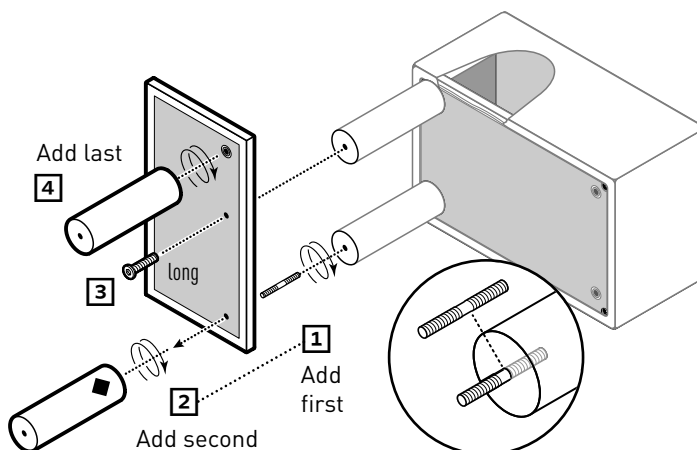
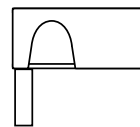
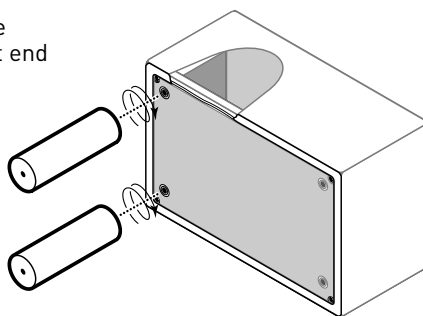

- 1 add the screwpost to the back left corner **scratching post**
- 2 add the **short platform** onto the screwpost; twist the **P4◆ post** onto the exposed end of the screwpost
- 3 attach the middle post to the platform with a long hex screw
- 4 twist the **P4 post** into the threaded hole

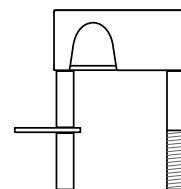
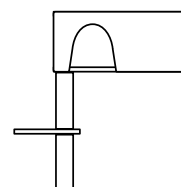
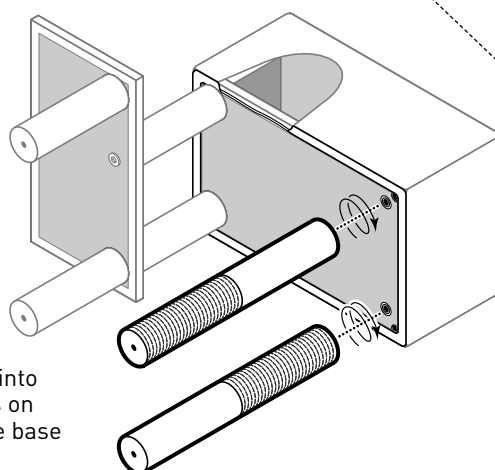

## 3 PIECES

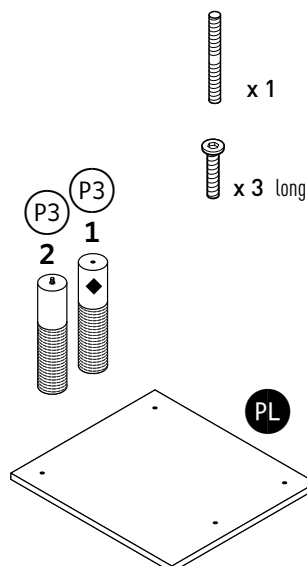

- 1 add the screwpost to the back right corner **scratching post**
- 2 add the **platform** onto the screwpost; twist the **P3◆ post** onto the exposed end of the screwpost
- 3 twist the remaining **P3 post** into the threaded hole in the top right corner

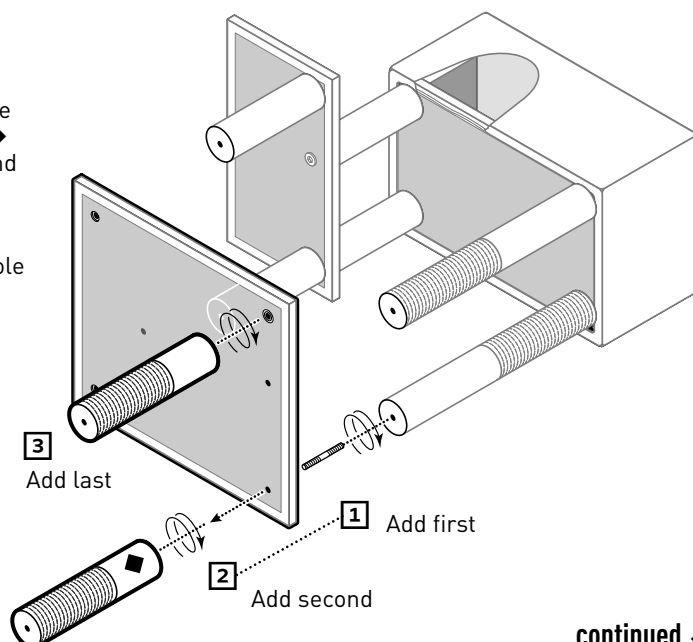



...continued ↗

# 3 ...continued

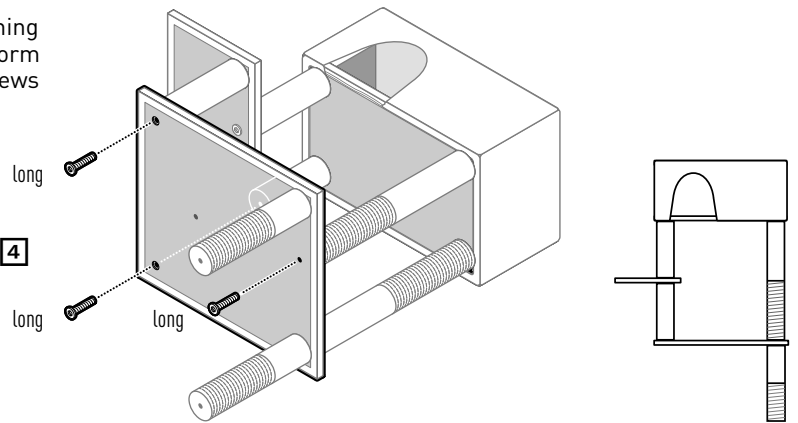
- 4** attach the remaining posts to the platform with long hex screws



# 4 PIECES

- A** **B**  
  x 2 short  
 x 2 long

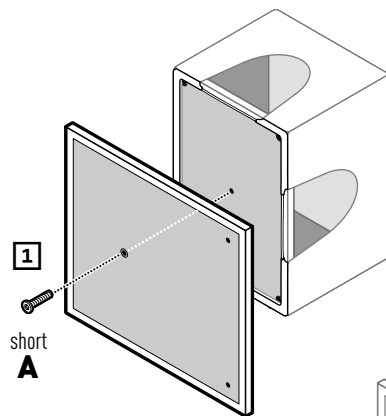
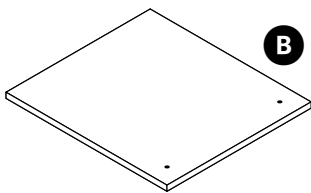
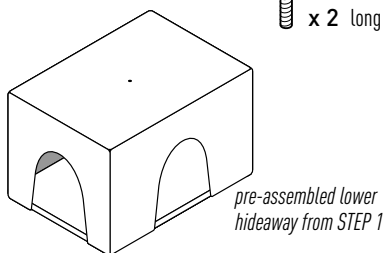

- 1** attach the pre-assembled hideaway from Step 1 to the base with short hex screw (A)

- 2** attach the hideaway/base unit to the full tower with: the shortest hex screw (B) through the hideaway roof into the platform; long hex screws through the base into the scratching posts.

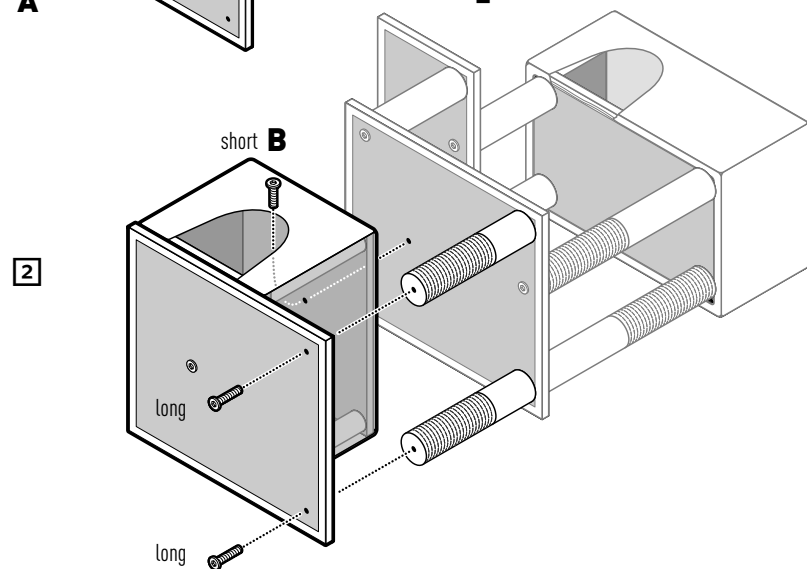

# 5 PIECES

-  x 1 long

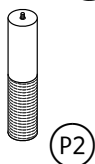
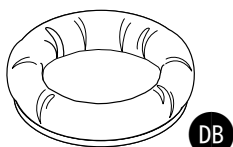

- 1** attach the post to the hideaway  
**2** spin the daybed onto the screwpost

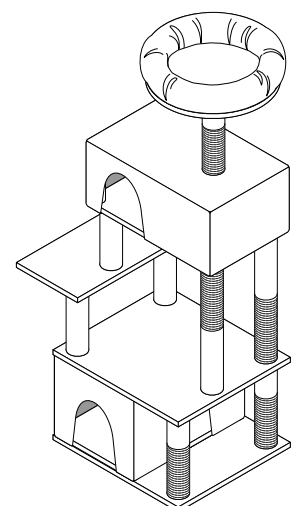
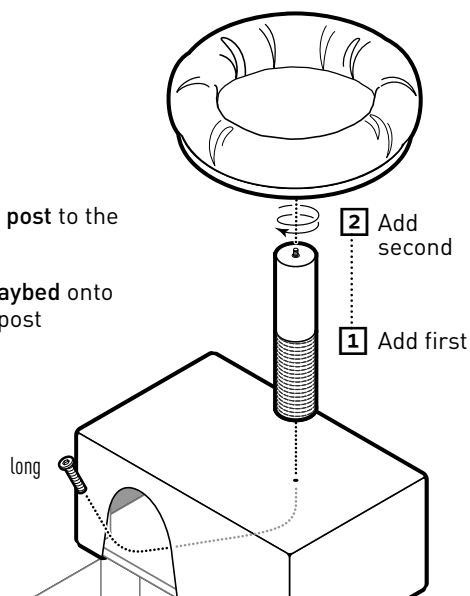

Assembly completed. 