

KEY:

DB = Daybed

TA = Toy Arm

P(x) = Post { A, B, C, D, E }

FL = Floor platform

HR = Hideaway Roof

HB = Hideaway Base

HARDWARE :



Short Hex Screw
2 pieces



Long Hex Screw
4 pieces



Screw Post
11 piece

TOOLS :



Hex Key
included



These parts are
interchangeable :

PA all 6 posts

PB both posts

PD 1 = PD 2

Both Hammocks

Posts by length



PA
x6



PB
x2



PC
x1



PD
x3



PE
x2

Follow the Assembly Steps in the order presented for best results.

1 PIECES

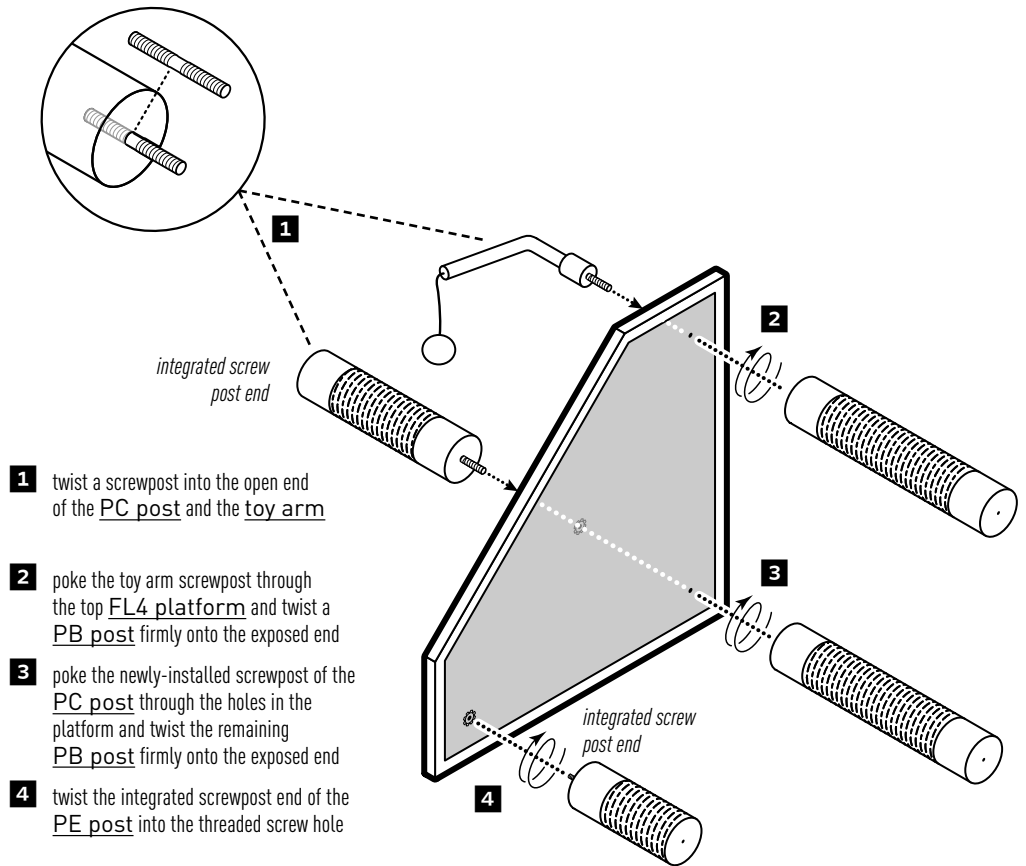
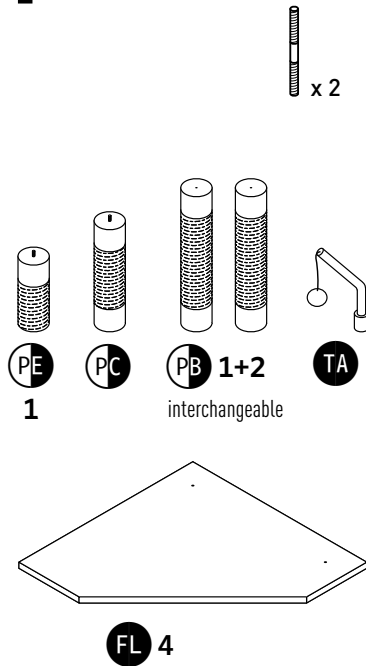

- 1** twist a screwpost into the open end of the PC post and the toy arm
- 2** poke the toy arm screwpost through the top FL4 platform and twist a PB post firmly onto the exposed end
- 3** poke the newly-installed screwpost of the PC post through the holes in the platform and twist the remaining PB post firmly onto the exposed end
- 4** twist the integrated screwpost end of the PE post into the threaded screw hole

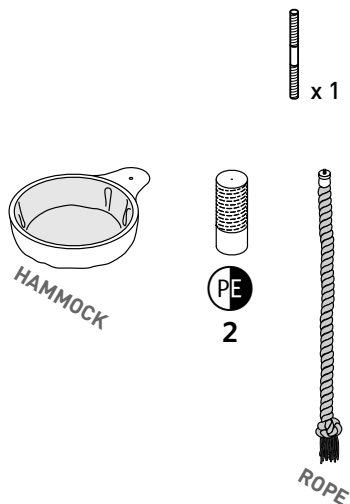

- 5** twist a screwpost into the open end of the installed PE post
- 6** insert the hammock onto the screwpost and twist the remaining PE post firmly onto the exposed end
- 7** install the rope now or during the very last step of this tower assembly

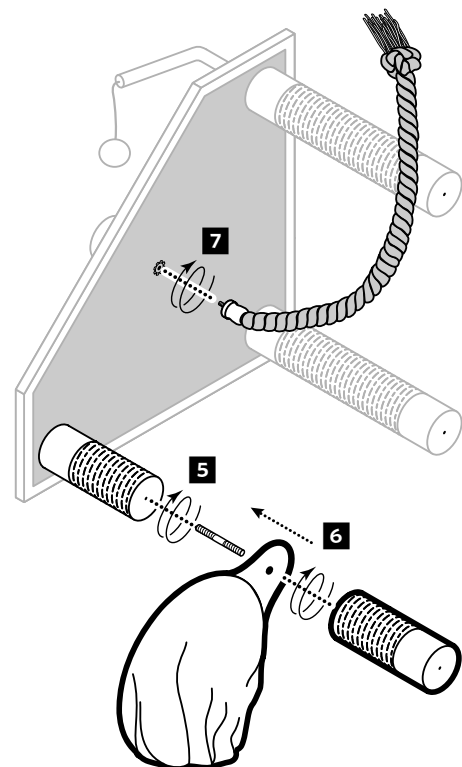

2 PIECES

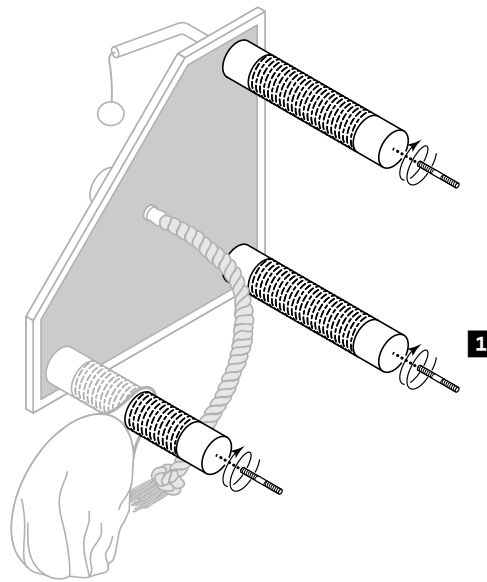
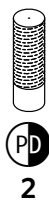
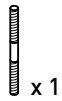
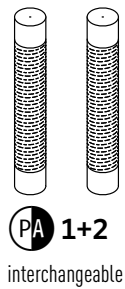
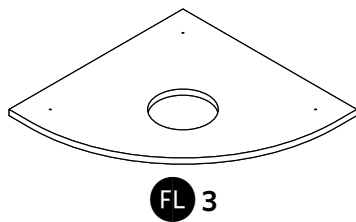

- 1 twist a screwpost into the open end of all three posts

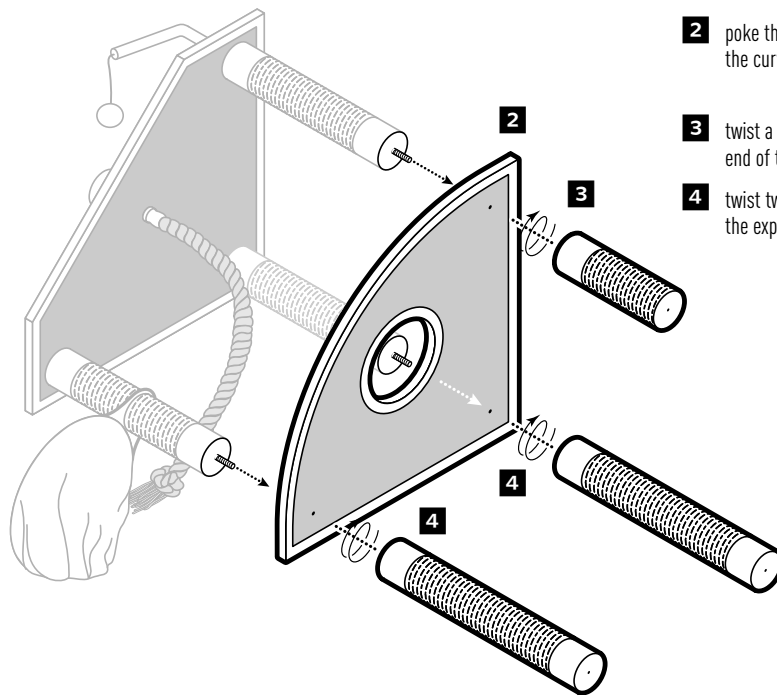

- 2 poke the screwposts through the holes in the curved-floor FL3 platform
- 3 twist a PD post firmly onto the exposed end of the screwpost indicated
- 4 twist two of the PA posts firmly onto the exposed screwposts indicated

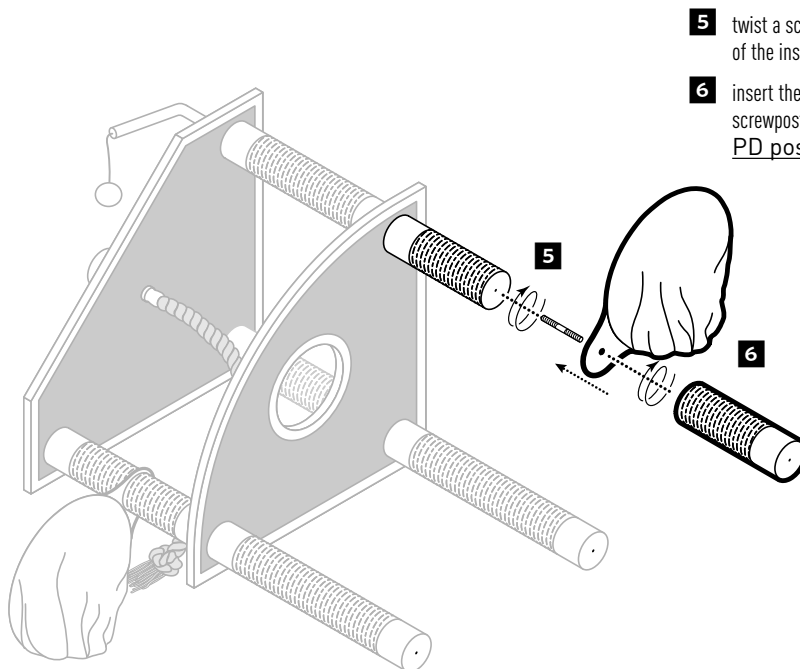

- 5 twist a screwpost into the open end of the installed PD post
- 6 insert the hammock onto the screwpost and twist the remaining PD post firmly onto the exposed end

3 PIECES

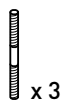

x 3

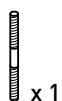

x 1

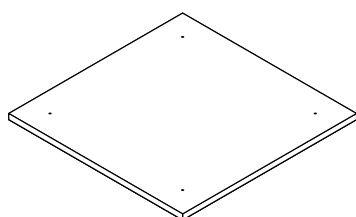

FL 2

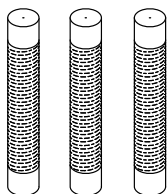

PA 3+4+5
interchangeable



PD 3



PA 6

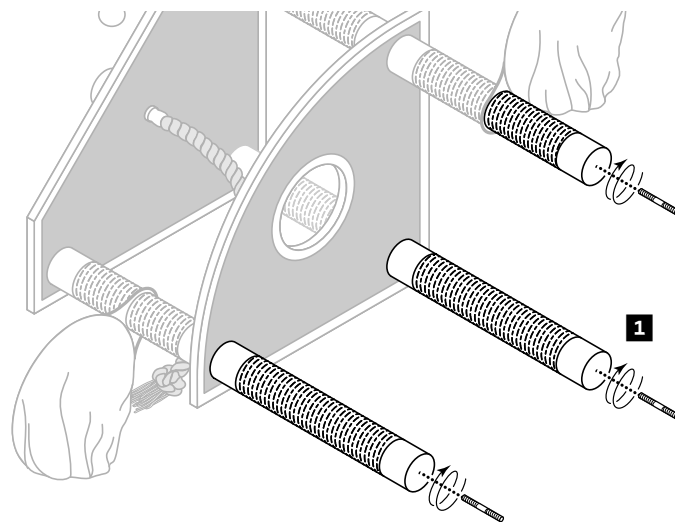

1 twist a screwpost into the open end of all three posts

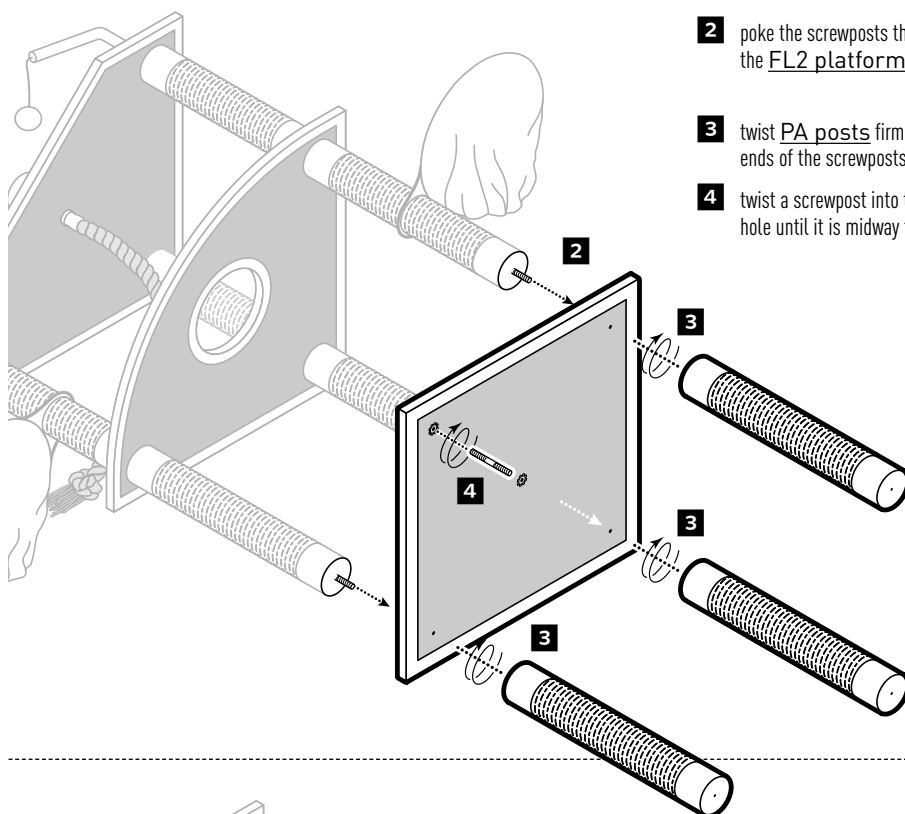

2 poke the screwposts through the holes in the FL2 platform

3 twist PA posts firmly onto the exposed ends of the screwposts

4 twist a screwpost into the threaded screw hole until it is midway through the hole

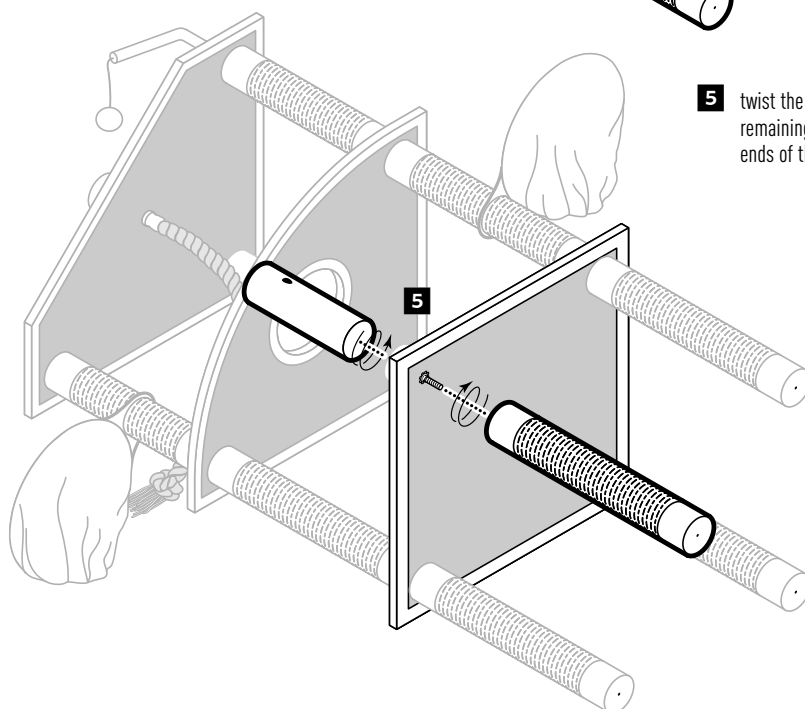

5 twist the all-fabric PD post and the remaining PA post onto the exposed ends of the screwpost as indicated

4 PIECES

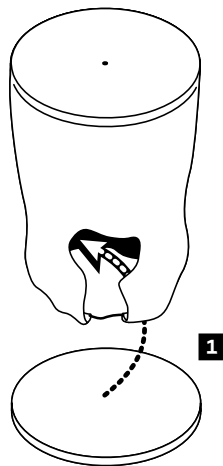
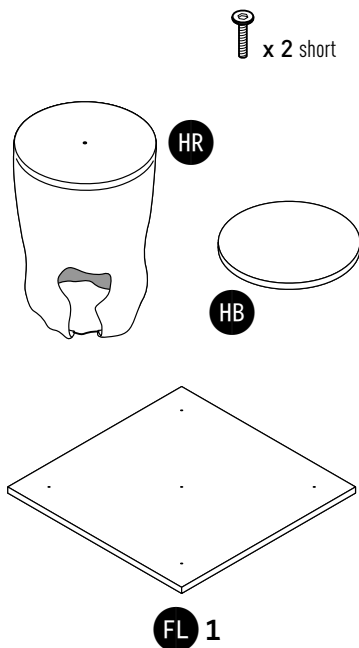

the hideaway fabric shell is attached to the hideaway roof

- 1 insert the hideaway base into the shell and let the elastic band reach under the lip of the base

- 2 attach the hideaway base to the FL1 platform with a short hex screw

★ leave screw loose enough to trap the elastic/fabric but allow some fabric to gently pull out as you attach the roof

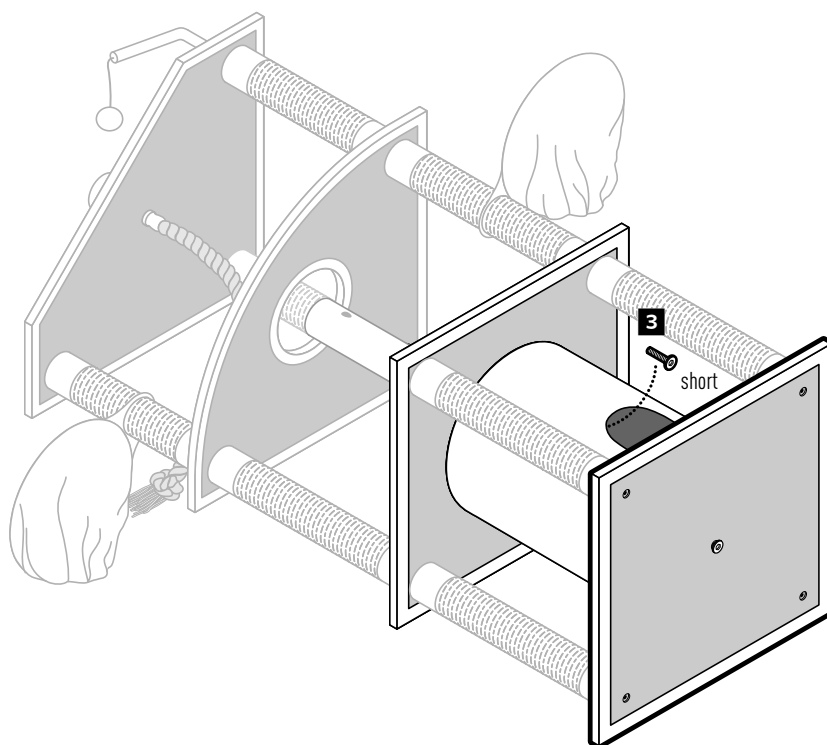
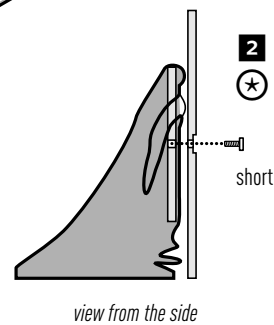
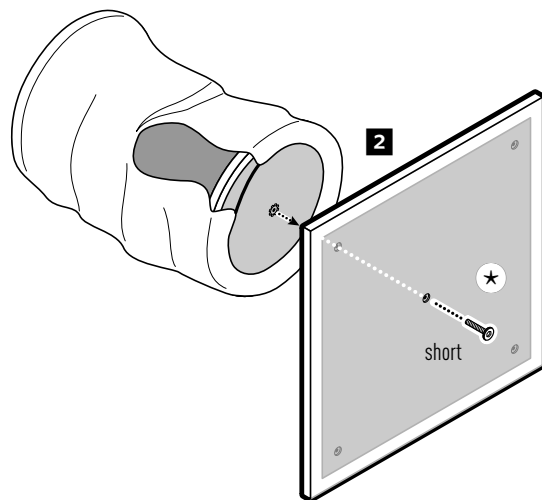

the fabric shell should stretch and gently pull out from under the base to form a nice, tight hideaway shape

- 3 with the remaining short hex screw, attach the hideaway roof to the underside of the platform

★ leave the top screw slightly loose

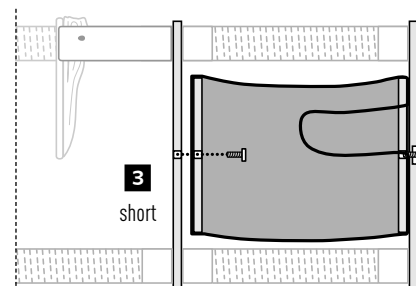

view from the side

 x 4 long

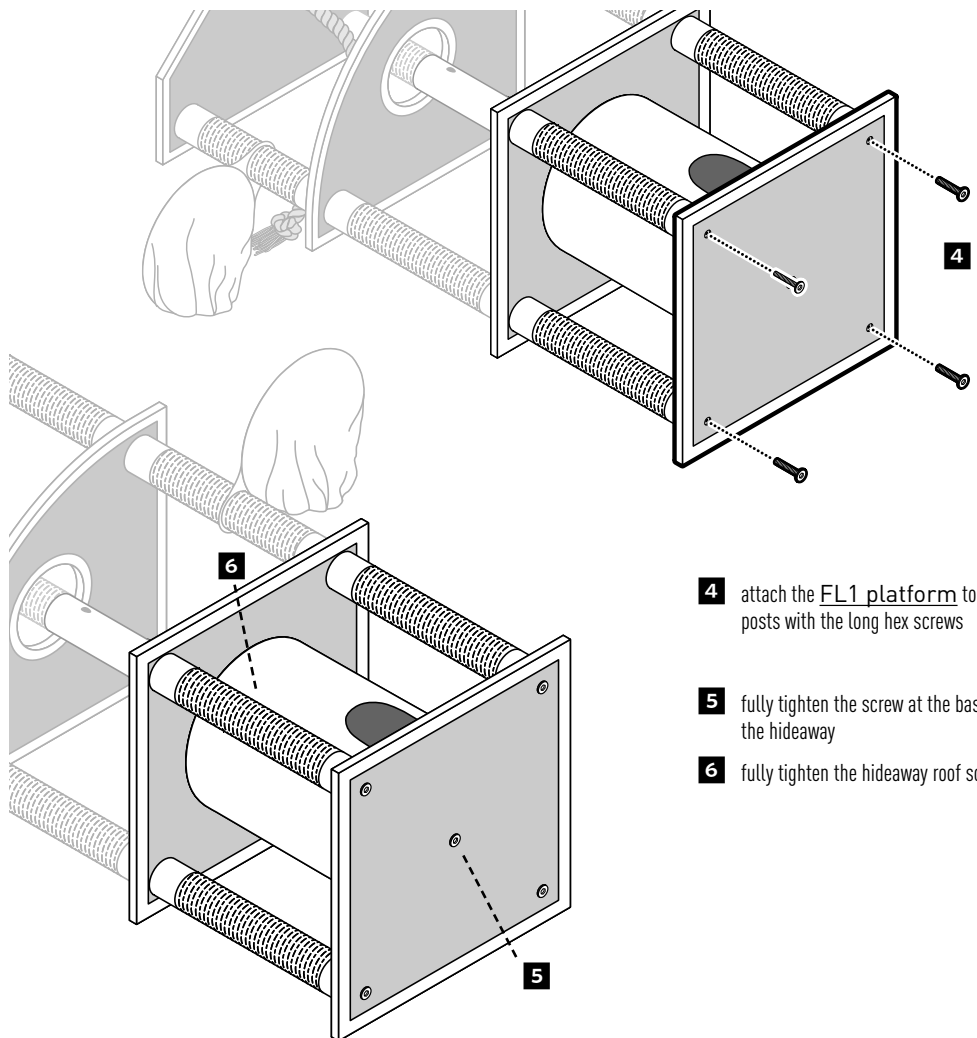

4 attach the **FL1 platform** to the posts with the long hex screws

5 fully tighten the screw at the base of the hideaway

6 fully tighten the hideaway roof screw

5 PIECES

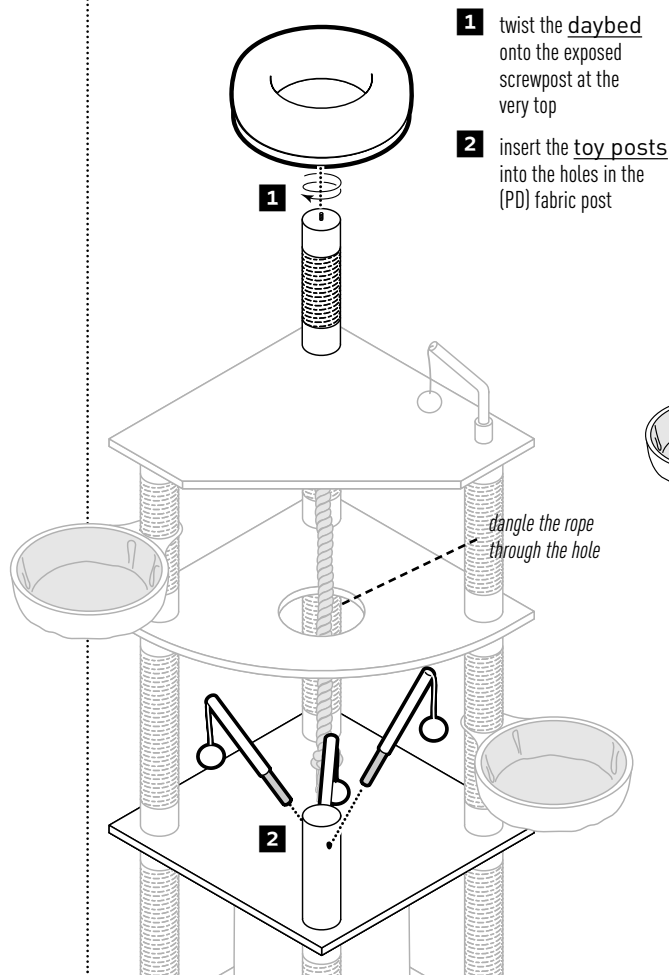
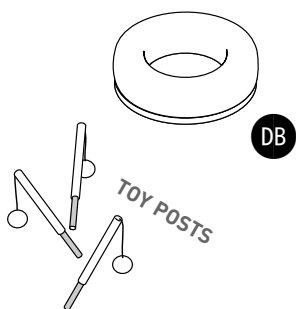

1 twist the **daybed** onto the exposed screwpost at the very top

2 insert the **toy posts** into the holes in the (PD) fabric post

dangle the rope through the hole

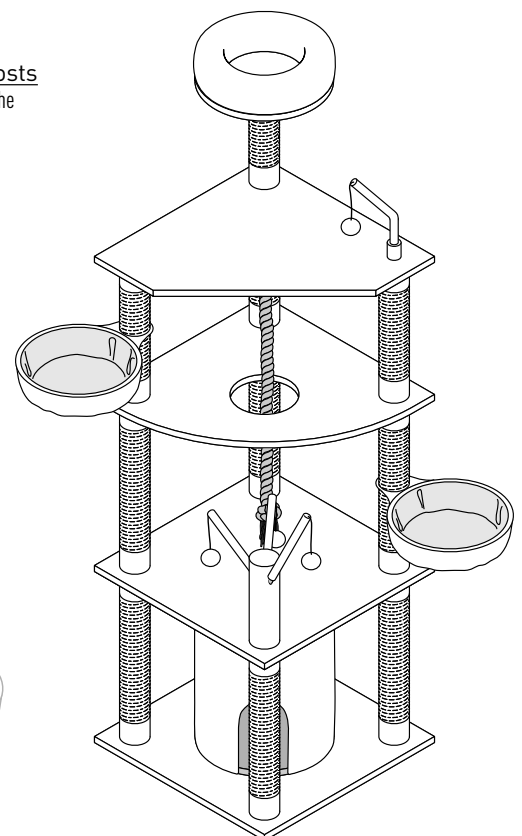

Assembly completed. 