

1 PIECES

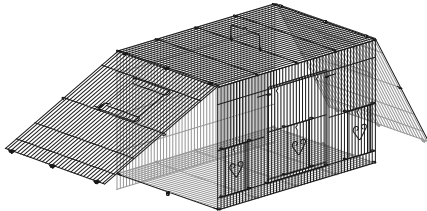

With the cage **UPSIDE DOWN**, unfold the **cage body** to create a box shape, then fold the sides up:

1 Catch the side panel hooks over the edge wires of the back and front panels.

2 Hook the tab on the floor grille under the corresponding horizontal wire.

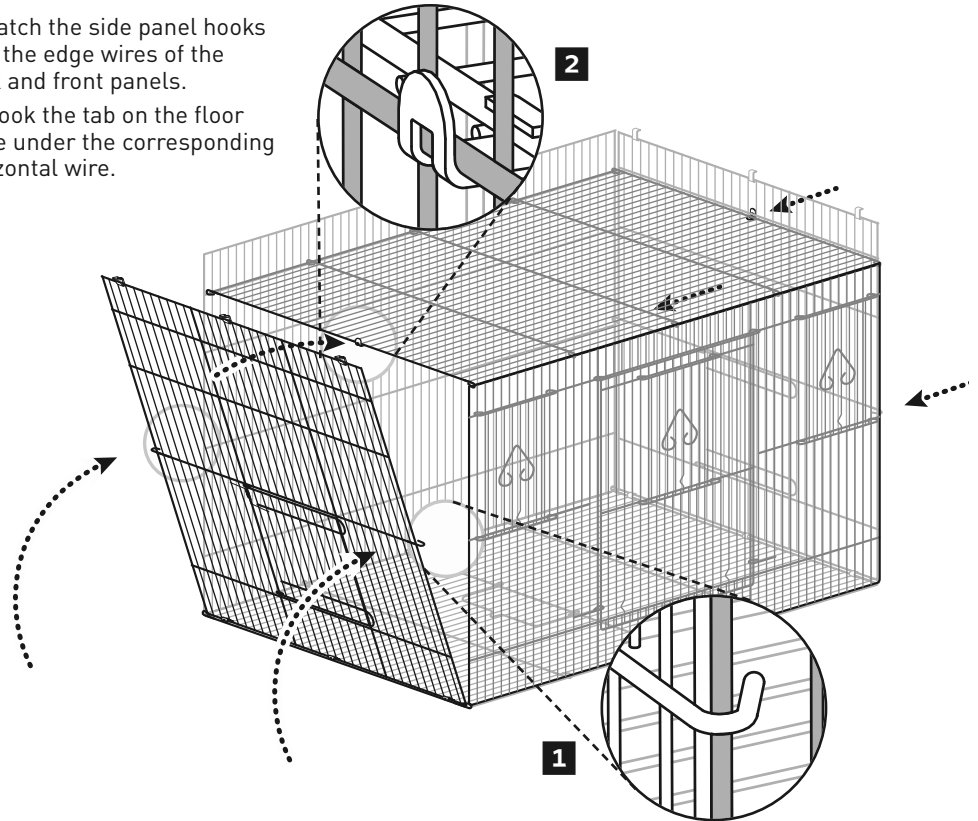

2 PIECES

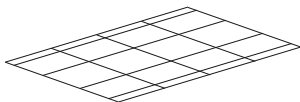

At one end, catch the **base grille** under the tabs. Rotate the grille down and catch under the tabs on the opposite side.

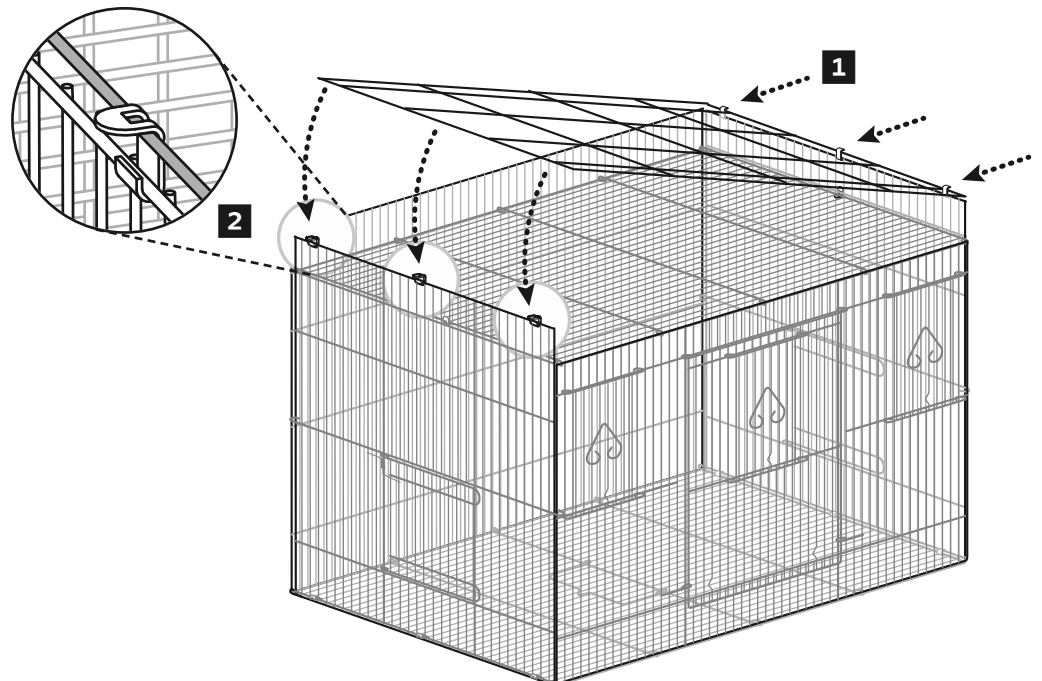

3 PIECES

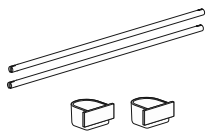

Turn the cage right-side-up, and add the components:

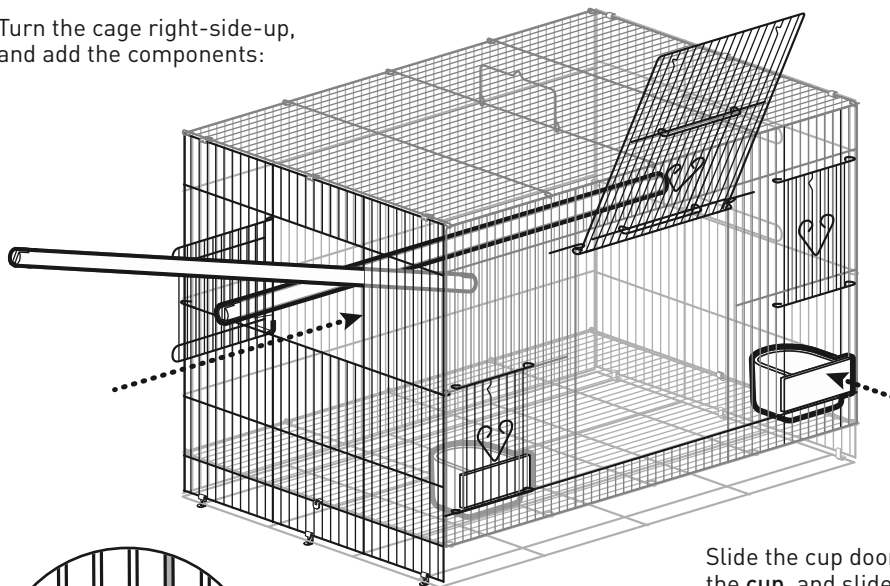

Slide the cup door up, insert the **cup**, and slide the door down over the cup back, to hold it in place.



Slide the **perches** in through the side door, and insert the perch slots over vertical wires. Settle the perch down onto a horizontal wire for stability.

4 PIECES

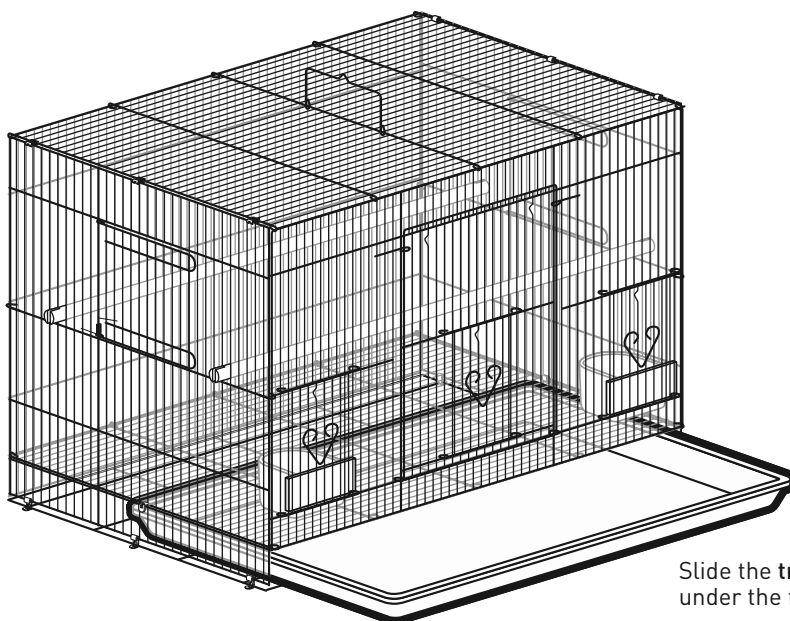
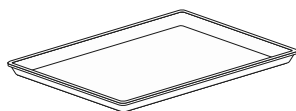

Slide the **tray** in place under the floor grille.

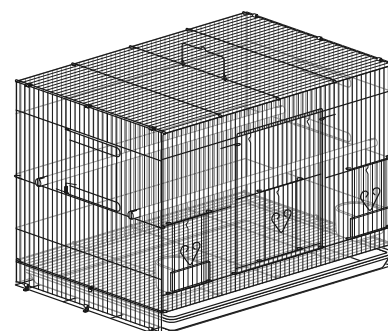

Assembly completed. ■